

For Lease

1000 Queen Street West
Toronto, ON



hullmark

Salient Details

Available Area:

Ground Floor: 2,204 sq. ft.

Mezzanine: 324 sq. ft.

Lower Level: 2,221 sq. ft.

Key Highlights

- Prime retail located on the corner of Queen Street West and Ossington Avenue and in proximity to over 265,000 residents and over 5 million SF of office.

- Toronto's most electric restaurant and bar scene featuring La Banane, Mamakas, Bellwoods Brewery & Union.



Offering

Net Rent: Please contact listing agents

Additional Rent: \$90,000 per year (estimate for 2020)

Availability: Immediate

- The area is a well curated retail node with Reigning Champ, Fred Perry, Aesop, Nadege, Le Labo, gravitypop, Burton, Ollie Quinn and Tiger of Sweden as key tenants.



Building Summary

An exceptional opportunity to occupy 4,425 square feet of new at grade retail space located on the North East corner of Ossington Avenue and Queen Street West. The area is currently experiencing significant gentrification and is home to thousands of young and trendy professionals with above average incomes.

Corner frontage visibility and high clear ceiling heights will give retailers an unprecedented branding opportunity in Queen West, considered one of the hippest neighbourhoods in the world by Vogue Magazine.



Floorplan

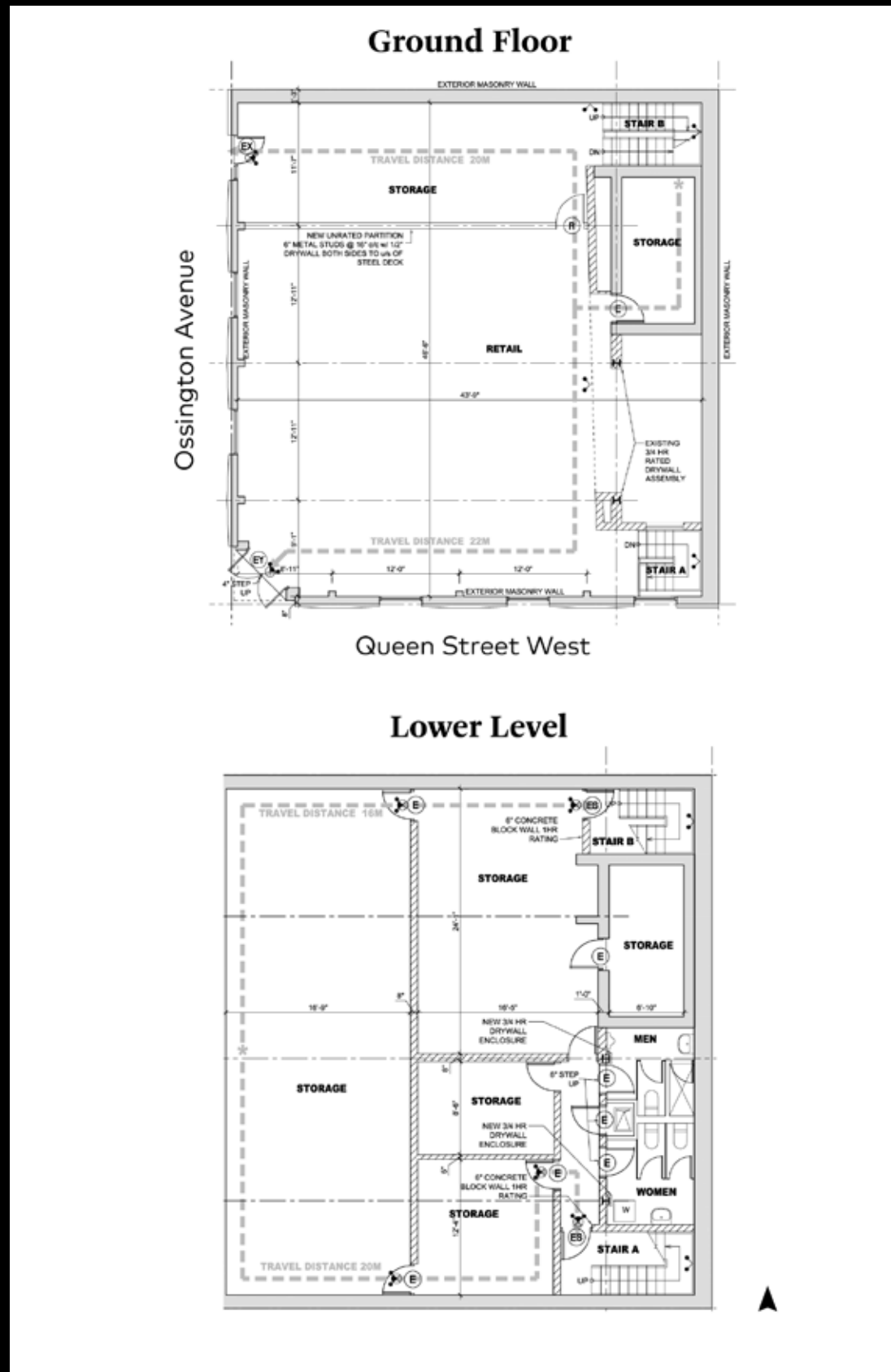

Interior Photos

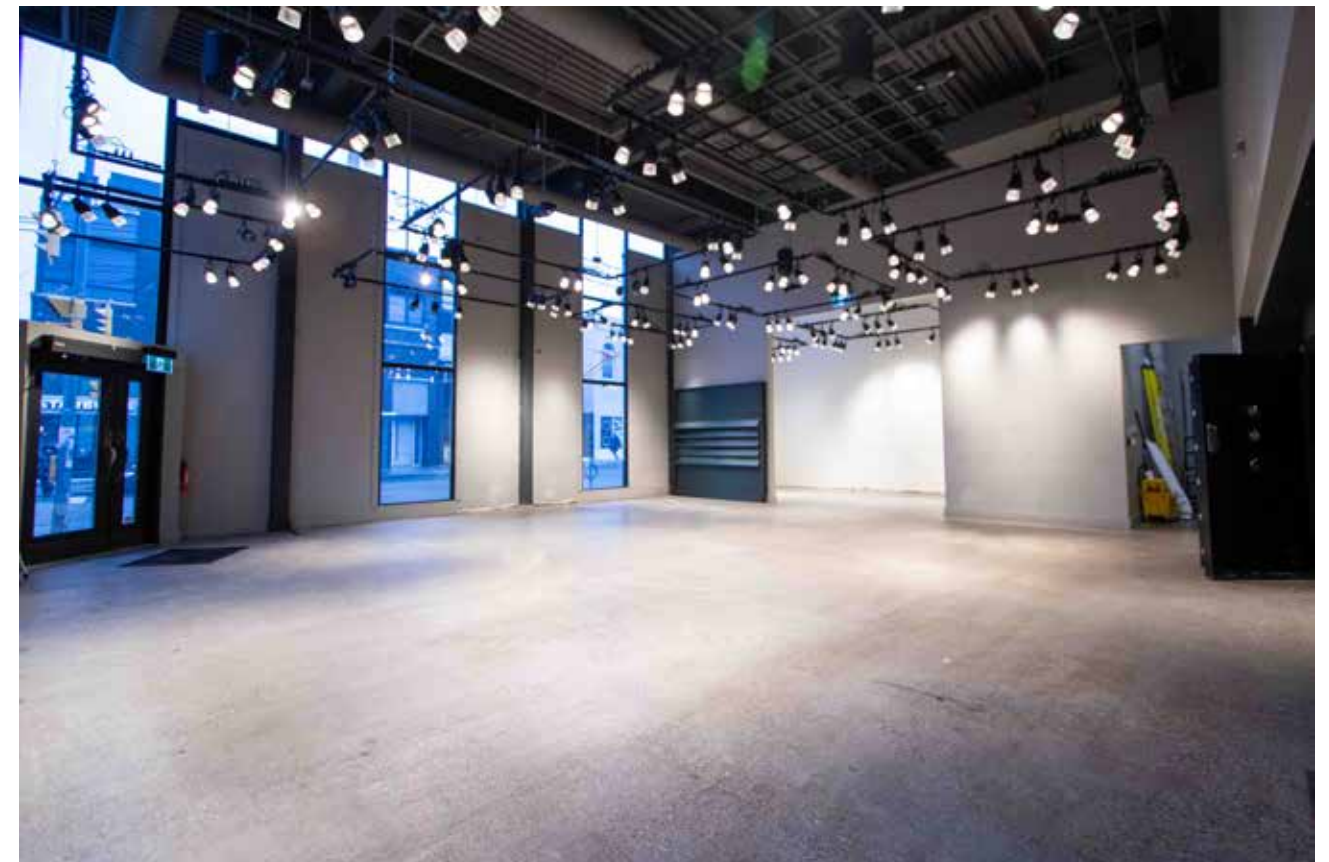



FINANCIAL CORE

**DOWNTOWN WEST OFFICE/
ENTERTAINMENT DISTRICT**

LIBERTY VILLAGE

**505 DUNDAS
STREETCAR**

TRINITY BELLWOODS PARK

WEST QUEEN WEST

7%
Population Change
(2018-2023)*

257,603
Population

34.3
Median Age*

\$110,990
Average Household Income



1000 Queen Street W

**501 QUEEN
STREETCAR**

Streetscape Map

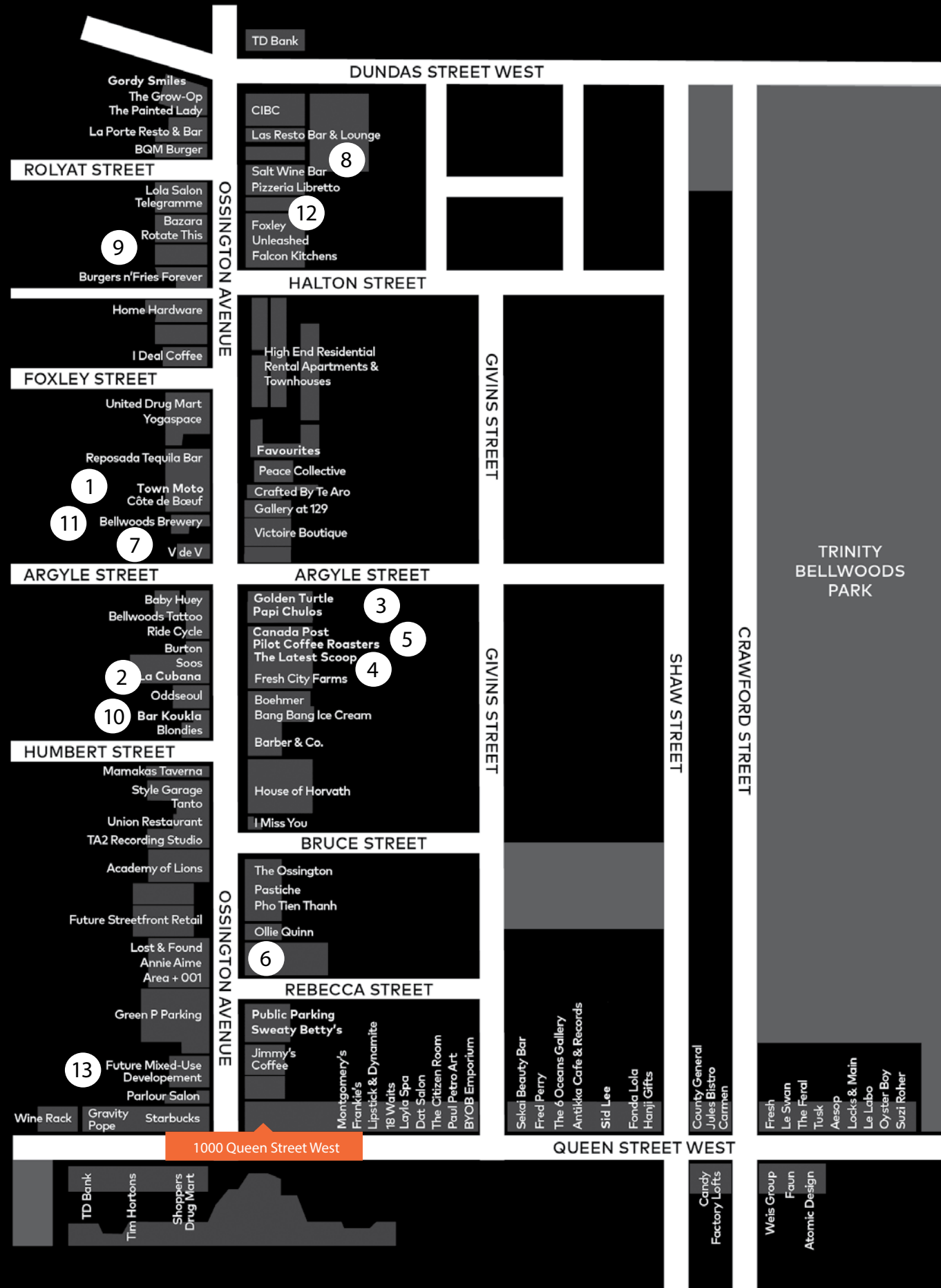

Ossington



Here Here, a neighbourhood magazine published in 2019 by Hullmark in collaboration with Public Address. They interviewed and documented the people, buildings and businesses that define the Ossington community.



1
Doubleknaut Design
 134 Ossington



3
Golden Turtle Restaurant
 125 Ossington



2
La Cubana
 92 Ossington



4
Muhammad Ali vs George Chuvalo
 109 Ossington

In March 1966, Muhammad Ali trained at 109 Ossington to fight Toronto-born George Chuvalo for the World Boxing Council heavyweight championship at Maple Leaf Gardens.



5
Pilot Coffee Roasters
 117 Ossington



6
Reigning Champ
 41 Ossington

"Here we're made up of so many different cultures and I think that contributes to our openness to try new things."

Brandon Olsen
La Banane
 92 Ossington

8



7
V de V
 120 Ossington

9
Favorites / Superpoint
 141 & 184 Ossington



10
Misfitstudio
 88 Ossington



11
Bellwoods Brewery
 124 Ossington



13
Fire Hall No.9, 1955
 (Courtesy of Toronto Public Library)



13
12 Ossington
 Designed by Hariri Pontarini Architects

"Ossington is an old street that carries a lot of history. History can be seen in its old brick buildings and industrial charm."

Gianpiero Pugliese
Audax Architecture

12

Interior Photos



Hullmark
474 Wellington Street West
Toronto, ON M5V 1E3
t: 416.510.1700
www.hullmark.ca



CBRE Limited.
145 King Street West, Suite 1100
Toronto, ON MH 1J8
t: 416.362.2244
www.cbre.ca



Information

Contact

Arlin Markowitz*

Senior Vice President

Urban Retail Team

t: 416.815.2374

arlin.markowitz@cbre.com

Jackson Turner**

Associate Vice President

Urban Retail Team

t: 416.815.2394

jackson.turner@cbre.com

Alex Edmison*

Senior Vice President

Urban Retail Team

t: 416.874.7266

alex.edmison@cbre.com

Teddy Taggart*

Sales Associate

Urban Retail Team

t: 416.847.3254

teddy.taggart@cbre.com

*Sales Representative, **Broker

This disclaimer shall apply to CBRE Limited, Real Estate Brokerage, and to all other divisions of the Corporation; to include all employees and independent contractors ("CBRE"). The information set out herein, including, without limitation, any projections, images, opinions, assumptions and estimates obtained from third parties (the "Information") has not been verified by CBRE, and CBRE does not represent, warrant or guarantee the accuracy, correctness and completeness of the Information. CBRE does not accept or assume any responsibility or liability, direct or consequential, for the Information or the recipient's reliance upon the Information. The recipient of the Information should take such steps as the recipient may deem necessary to verify the Information prior to placing any reliance upon the Information. The Information may change and any property described in the Information may be withdrawn from the market at any time without notice or obligation to the recipient from CBRE. CBRE and the CBRE logo are the service marks of CBRE Limited and/or its affiliated or related companies in other countries. All other marks displayed on this document are the property of their respective owners. All Rights Reserved.