

FOR SALE

# 2301-2315 Danforth Avenue

Retail For Sale

At the Corner of Danforth Ave & Morton Rd



CBRE



## PROPERTY HIGHLIGHTS

CBRE Limited is pleased to offer for sale on behalf of the Vendor, Danmor Developments Limited, ground floor retail space in Danforth Village. The Property is located at the base of the currently under-construction Canvas Condominium. The Property provides users and investors with an opportunity to acquire brand new, transit connected right-sized space. The property features 4,225 sq. ft. of commercial space below 170 residential units.

2301-2315 Danforth Avenue retail comprises of four units totalling 4,255 sq. ft. of prime retail space under a brand new 8 storey condominium building constructed by Marlin Springs. Located on the southwest corner of Danforth Avenue and Morton Road, this new development sits at the edge of the Danforth Village and adjacent to the Upper Beaches neighbourhood.

**\*Price | \$425,000 - \$2,899,999**

**598 - 4,255 sq. ft. Available**



## BRAND NEW DEVELOPMENT

Currently under construction, Canvas Condos is an 8 storey mixed-use building with 170 residential units designed by Graziani + Corazza Architects.



## TRANSIT CONNECTED

Conveniently located, Canvas Condos is near accessible public transportation with both the Woodbine and Main Street subway stations situated nearby.



## AMAZING EXPOSURE

Fronting on Danforth Avenue this property has amazing exposure and very prominent and wide (over 180 ft.) frontage on the corner

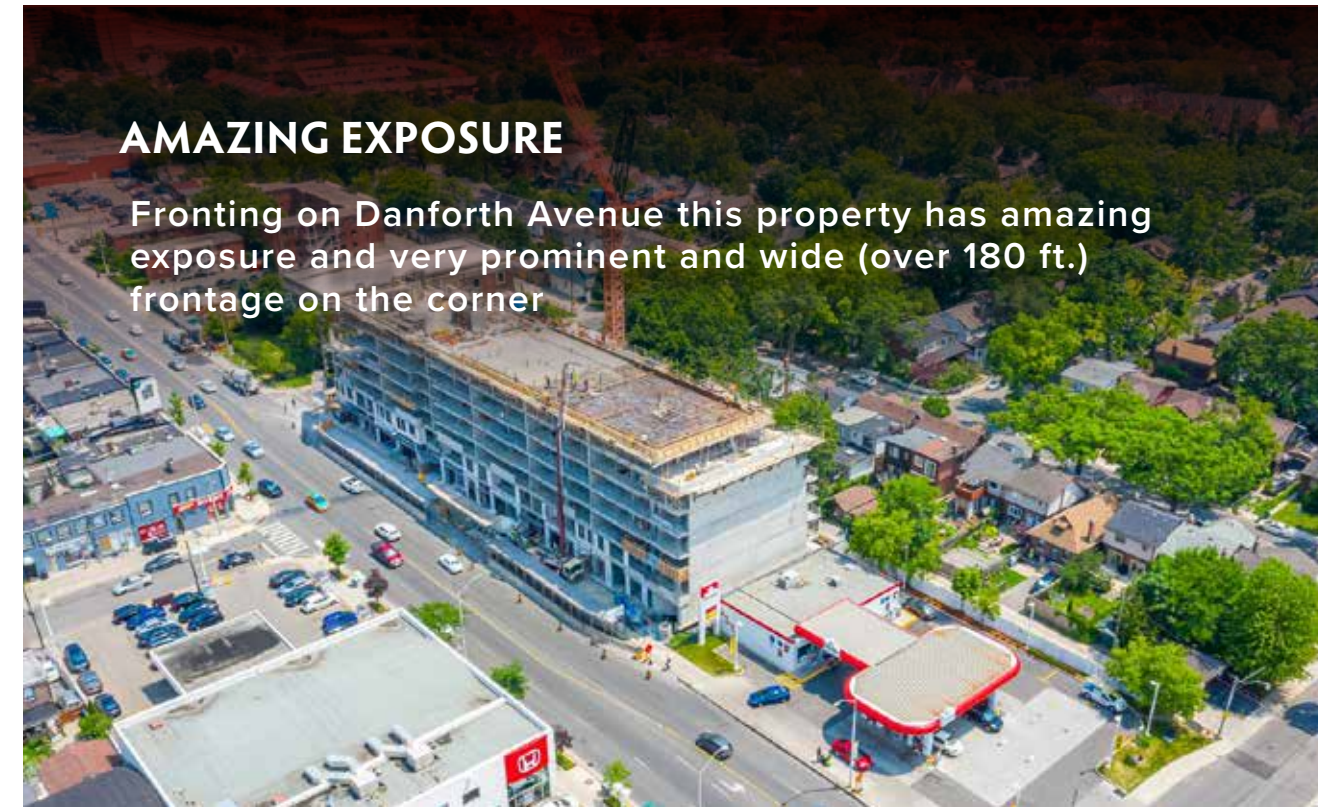

## USER OR INVESTOR OPPORTUNITY

The property lends itself as a unique opportunity for both investor or users to acquire right sized space. Purpose built, condo retail space is ideal for a wide array of users who desire street front exposure as well as efficient floor space.





PROPERTY DETAILS

	SIZE	PRICE
Retail Unit One	598 sq. ft.	\$425,000
Retail Unit Two	966 sq. ft.	\$675,000
Retail Unit Three	1,016 sq. ft.	\$700,000
Retail Unit Four	1,675 sq. ft.	\$1,200,000
Full Retail Space	4,255 sq. ft.	\$2,899,999

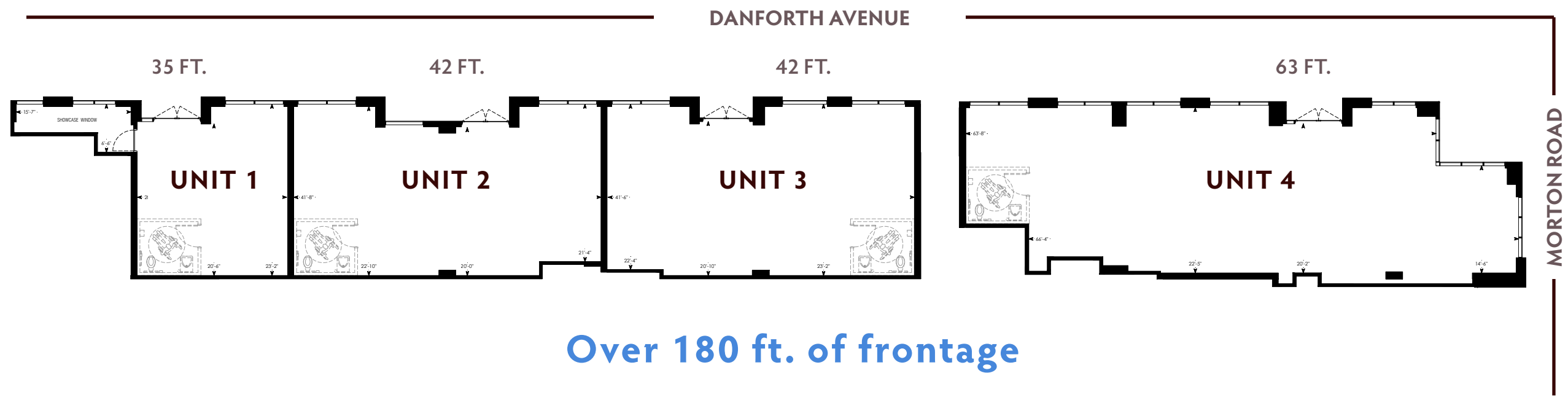
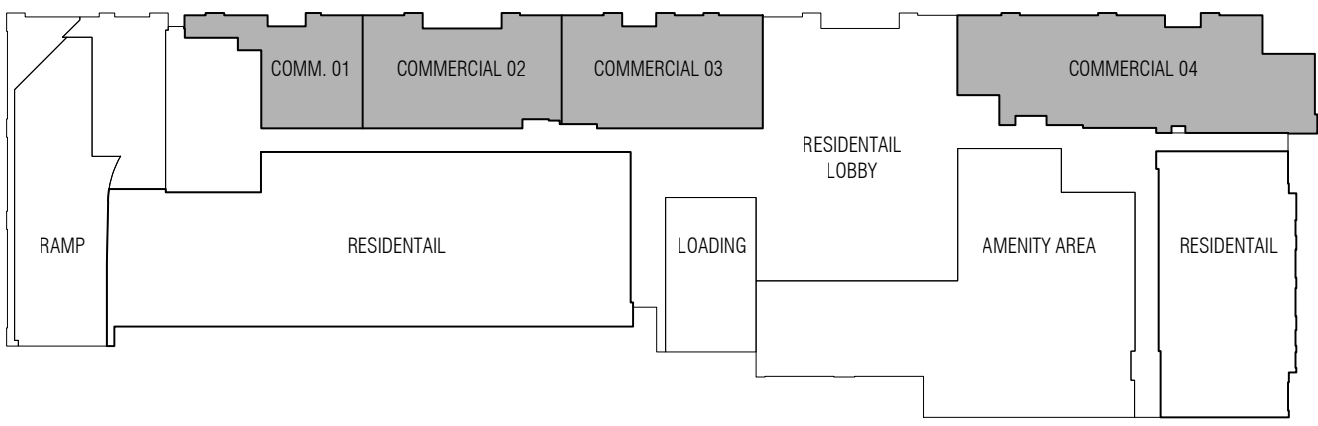

Canvas Condo Retail



Canvas Condo Retail



# THE DANFORTH

Danforth Village is a popular residential neighborhood in the east end of the city known for its multicultural residents, strong sense of community and unique charm. It is an in-demand neighbourhood for families given its proximity to downtown, access to public transportation as well as the many parks and schools in the area.

Danforth Avenue, just east of Greenwood Avenue and west of Victoria Park Avenue, is the main retail strip of Danforth Village that consists of more than 300 businesses. The street is dominated by family-oriented independent shops and restaurants, as well necessary big box stores to supply all the neighbourhood needs.

The area sees an influx of visitors in the summer months when residents from all over the city flock to enjoy the one-of-a-kind retail, experience the abundance of parks and to make their way south to Woodbine Beach. Various events such as Taste of the Danforth, Danforth Rocks and Fall garden tours draw hundreds of visitors to the neighborhood each year.



Based on 2018 statistics within 2km radius



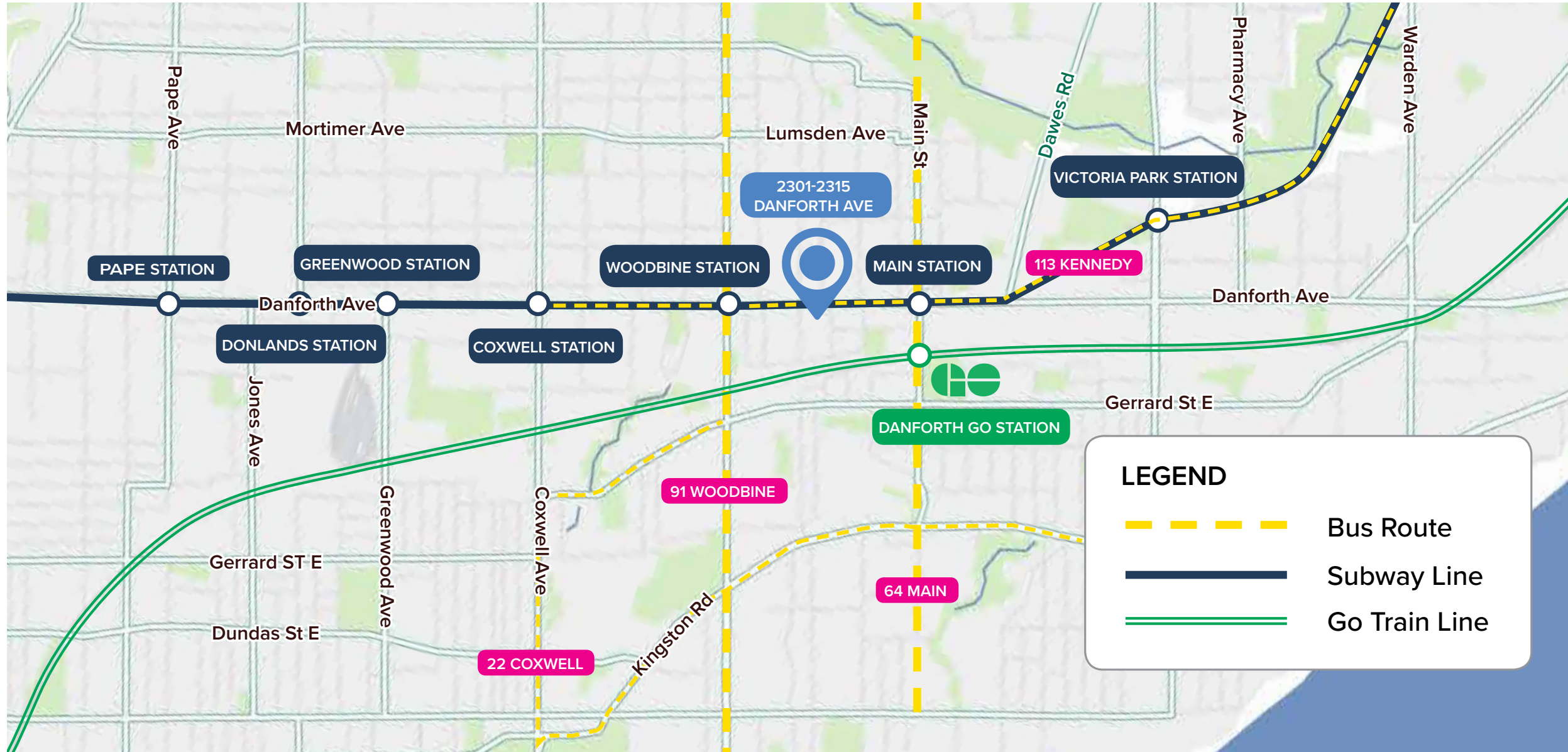

Based on 2018 statistics within 2km radius



**20,799**  
Drive to work



**20,678**  
Take Public Transit



**1,165**  
Bike



## TRANSIT OVERVIEW

2301 Danforth Avenue features excellent access to local and regional transportation. Its location directly on the TTC Bloor-Danforth line in between Woodbine and Main Street stations combined with its proximity to many TTC bus lines allows for access to many of Toronto's thriving neighborhoods, such as The Beaches. The Bloor-Danforth Subway line has 31 stations and runs east-west along Danforth Avenue and Bloor Street, operating from the western area of Dundas West & Kipling Avenue to Eglinton Avenue East and Kennedy Road.

The Property is a short walk of 650 meters to the Danforth GO station, allowing one to get to the downtown core in less than 25 minutes. The Danforth GO Station provides access to the GO transit network, which operates between Hamilton and Kitchener-Waterloo in the west, to Newcastle and Peterborough in the east, and from Orangeville and Beaverton in the north to Niagara Falls in the south.



# ABOUT THE BUILDER: MARLIN SPRINGS

With over 60 years of experience in the industry, Marlin springs is at the forefront of producing truly inspiring, forward-thinking and imaginative products. From boutique condominiums to townhome developments across the city in communities such as the Danforth Village/Upper Beaches, The Beach, Stockyards, Vaughan, Oshawa, and Markham.

In keeping with their vision, all Marlin Spring projects are in prime residential locations that offer strong potential for long-term value and growth. The founders and key principals of Marlin Spring have extensive industry experience as one of the leading real estate development companies in Canada.



# CONTACT

**Arlin Markowitz\***  
Senior Vice President  
416 815 2374  
arlin.markowitz@cbre.com

**Alex Edmison\***  
Vice President  
647 287 8316  
alex.edmison@cbre.com

**Jackson Turner\*\***  
Associate Vice President  
416 815 2394  
jackson.turner@cbre.com

**Teddy Taggart\***  
Sales Representative  
416 847 3254  
teddy.taggart@cbre.com

# CBRE

© 2019 CBRE, Inc. This disclaimer shall apply to CBRE Limited, Real Estate Brokerage, and to all other divisions of the Corporation; to include all employees and independent contractors ("CBRE"). The information set out herein, including, without limitation, any projections, images, opinions, assumptions and estimates obtained from third parties (the "Information") has not been verified by CBRE, and CBRE does not represent, warrant or guarantee the accuracy, correctness and completeness of the Information. CBRE does not accept or assume any responsibility or liability, direct or consequential, for the Information or the recipient's reliance upon the Information. The recipient of the Information should take such steps as the recipient may deem necessary to verify the Information prior to placing any reliance upon the Information. The Information may change and any property described in the Information may be withdrawn from the market at any time without notice or obligation to the recipient from CBRE. CBRE and the CBRE logo are the service marks of CBRE Limited and/or its affiliated or related companies in other countries. All other marks displayed on this document are the property of their respective owners. All Rights Reserved.