

110  
BLOOR

PRIME RETAIL  
**FOR LEASE**  
ON BLOOR STREET WEST



 CUSHMAN &  
WAKEFIELD

**CBRE**



Artist's rendering of  
proposed redevelopment  
of 110 Bloor Street West

# 110 BLOOR

---

Opportunity to lease a flagship retail space on the preeminent block on Bloor Street West.

---

Located within 100m of Cartier, Prada, Louis Vuitton, Tiffany & Co, Hermes and Gucci.

---

The property features direct subway access, underground parking, and accessibility from both Bloor Street West and Cumberland Street.

# 110 BLOOR

Size: Unit 1: 4,570 sq. ft.  
Unit 2: 6,400 sq. ft.  
+ Potential to add 13,000 sq. ft. basement

Net Rent: Please contact listing agents

TMI: \$118.00 per sq. ft.

Term: 5-10 years

Occupancy: Please contact listing agents

- Spaces may be combined to form one large unit
- Prominent storefronts with triple height facades
- Located between Louis Vuitton, Gucci and Tiffany & Co. to the west, and Zegna, Hermes and Holt Renfrew to the east

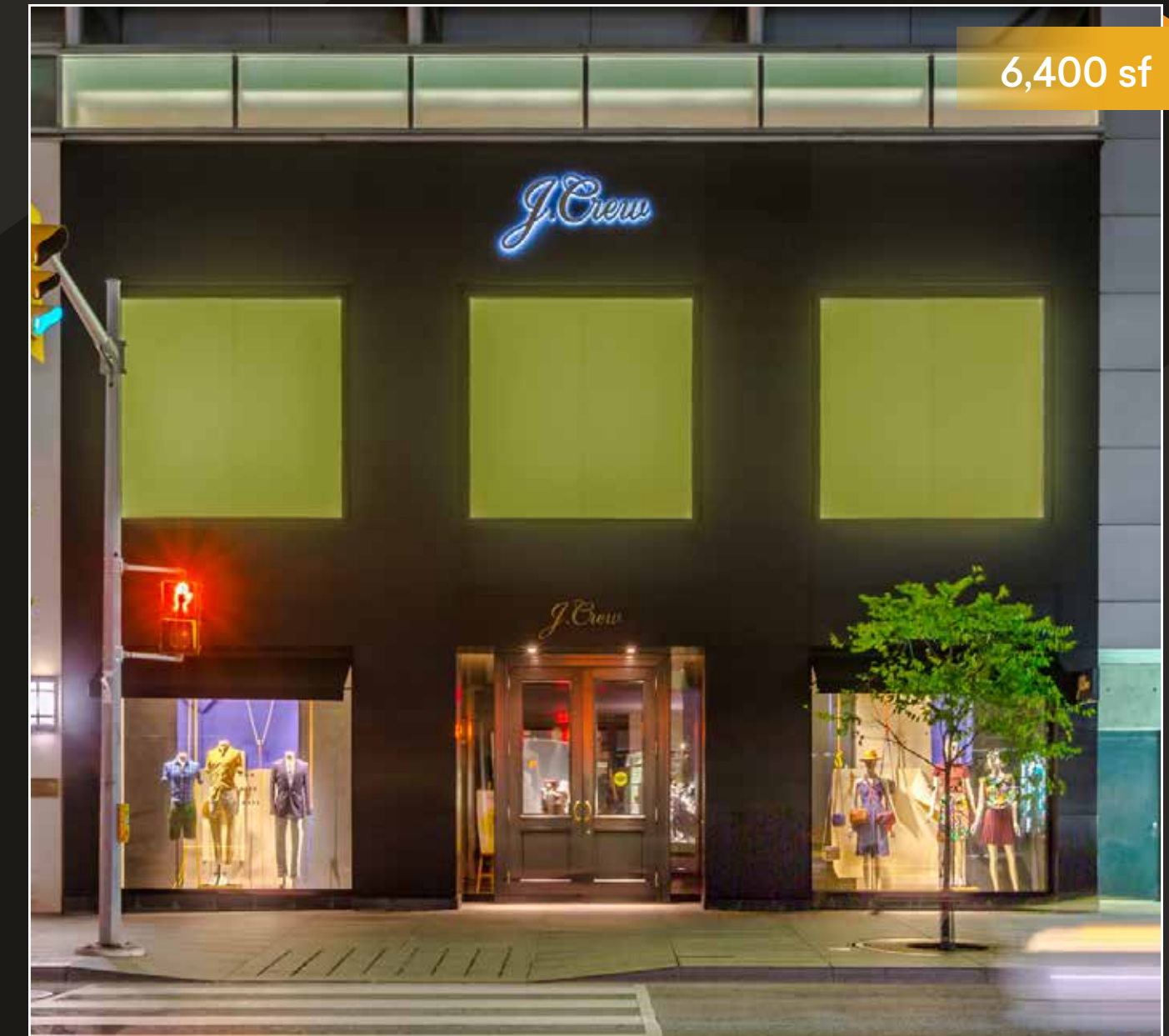

**110 BLOOR STREET WEST | FLOOR PLAN**

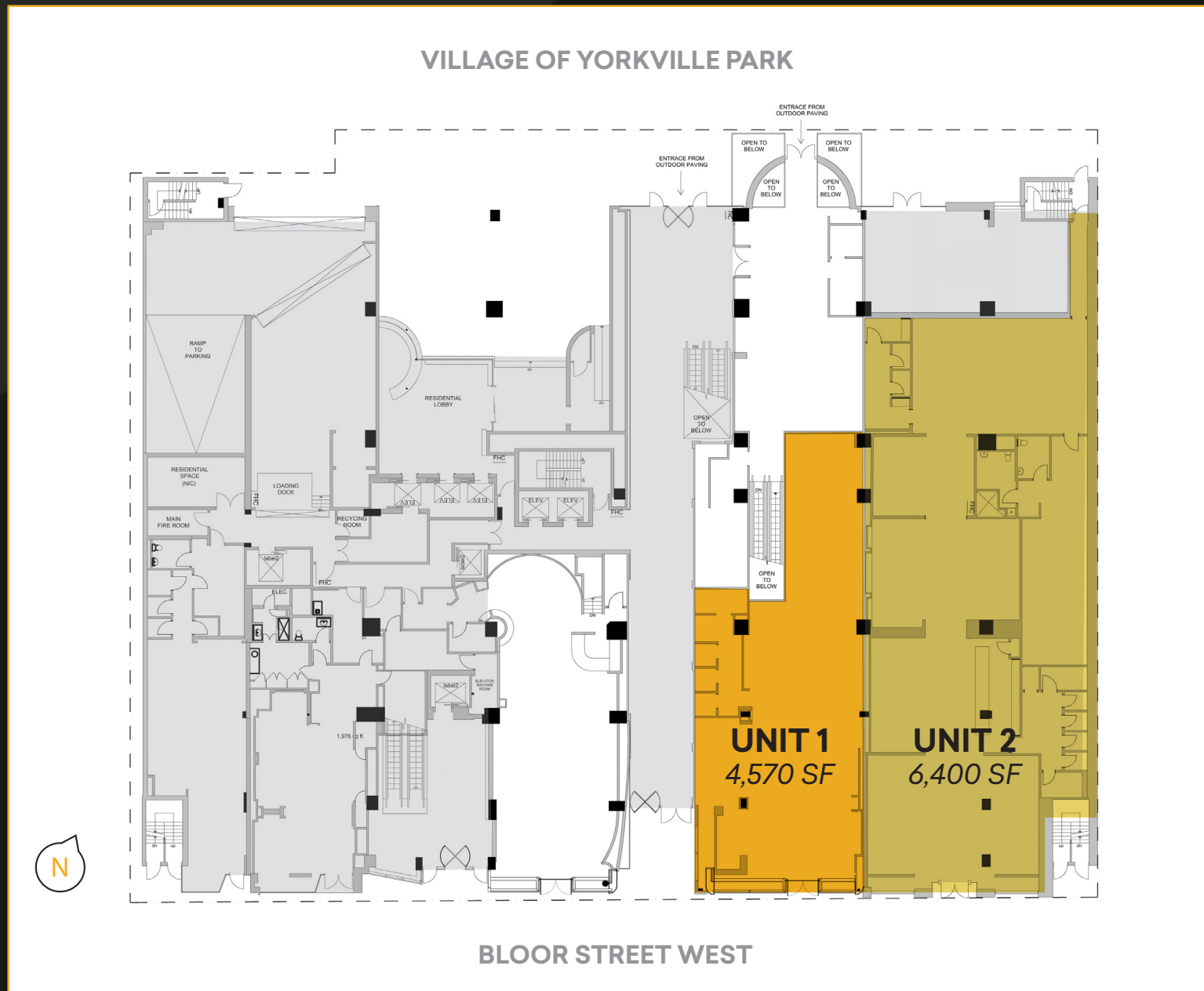

*Proposed 212 foot wide public art installation across the upper facade of 110 Bloor Street West*



# BLOOR yorkville RR

The Bloor-Yorkville node represents the pinnacle of Canadian high-street retail. The Yorkville and Cumberland area is recognized internationally as one of the top ten shopping destinations in the world, with high-end fashion uses dominating the street front. The area provides residents and tourists with the country's most prestigious selection of luxury and aspirational retailers demonstrating the highest net rental rates in Canada. The area boasts 2.3 million sq. ft. of retail space, 1.5 million of which is street-front. Retail sales performance along the Bloor Street corridor often exceeds \$2,500 per sq. ft.



Neighbouring Retailers



TIFFANY & Co.

GUCCI

ZZegna



HARRY ROSEN

SAINT LAURENT PARIS



ZARA

ARITZIA



VILLAGE OF YORKVILLE PARK

STARBUCKS

NESPRESSO

LULULEMON

AVEDA

NICOLAS

SEE EYE WEAR

110 BLOOR ST WEST

LANEWAY

110 BLOOR ST WEST

L'OCCITANE

KIT & ACE

LANEWAY

KUPFERT & KIM/  
BARRY'S  
BOOTCAMP

ZEGNA

HERMÉS

HOLT  
RENFREW  
MENS

BELLAIR STREET

HARRY  
ROSEN

BANANA REPUBLIC

ROOTS

66 BLOOR ST WEST

BAY STREET

THE GAP

HOLT RENFREW

SAINT  
LAURENT

ZARA

ARITZIA

SWAROVSKI

CIBC

HUDSON'S  
BAY

BLOOR STREET WEST

BLOOR STREET WEST

AVENUE ROAD

CLUB MONACO

PELTON

MONT BLANC

STUART WEITZMAN

MAX MARA

MONCLER

ESCADA

WILLIAM  
ASHLEY

CARTIER

MICHAEL KORS

PRADA

MULBERRY

COACH

CHRISTIAN DIOR

DOLCE & GABANA

ROYAL DEVERSAILLES

COLEHAAN

ST. THOMAS STREET

VICTORINOX

95 BLOOR ST

MCM

MAC

APM MONACO

COS

HUGO BOSS

SEPHORA

TD BANK

BAY STREET

BIRKS

EATALY  
MANULIFE CENTRE

BALMUTO STREET

SCOTIABANK

H&M

THE ONE  
DEVELOPMENT  
FUTURE APPLE  
STORE

YONGE STREET

NORDSTROM  
RACK  
CHICK-FIL-A  
MCEWAN'S

CLUB MONACO



D&G  
DOLCE & GABBANA

COS

SEPHORA



NORDSTROM  
rack



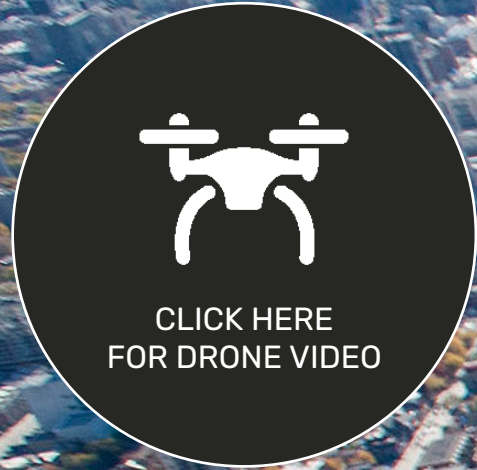

YONGE UNIVERSITY SUBWAY LINE

YONGE UNIVERSITY SUBWAY LINE

BLOOR-DANFORTH SUBWAY LINE

BLOOR-YONGE

QUEEN'S PARK

UNIVERSITY OF TORONTO

ROYAL ONTARIO MUSEUM

PARK HYATT

EATALY

110 BLOOR

BAY

HOLT RENFREW

FOUR SEASONS



# CONTACT



Cushman & Wakefield ULC, Brokerage  
161 Bay Street, Suite 1500  
Toronto, ON M5J 2S1  
cushwake.com



CBRE Real Estate Brokerage  
145 King Street West, Suite 1100  
Toronto, ON, M5H 1J8  
cbre.ca

For more information, please contact:

**Philip Traikos\***  
Senior Vice President  
Retail Services  
416 359 2455  
philip.traikos@cushwake.com

**Carmen Siegel\***  
Senior Associate  
Retail Services  
416 359 2365  
carmen.siegel@cushwake.com

**Arlin Markowitz\***  
Senior Vice President  
416.815.2374  
arlin.markowitz@cbre.com

\*Sales Representative

This disclaimer shall apply to CBRE Limited, Real Estate Brokerage, and to all other divisions of the Corporation; to include all employees and independent contractors ("CBRE"). The information set out herein, including, without limitation, any projections, images, opinions, assumptions and estimates obtained from third parties (the "Information") has not been verified by CBRE, and CBRE does not represent, warrant or guarantee the accuracy, correctness and completeness of the Information. CBRE does not accept or assume any responsibility or liability, direct or consequential, for the Information or the recipient's reliance upon the Information. The recipient of the Information should take such steps as the recipient may deem necessary to verify the Information prior to placing any reliance upon the Information. The Information may change and any property described in the Information may be withdrawn from the market at any time without notice or obligation to the recipient from CBRE. CBRE and the CBRE logo are the service marks of CBRE Limited and/or its affiliated or related companies in other countries. All other marks displayed on this document are the property of their respective owners. All Rights Reserved.