

FOR SALE: Toronto, ON

**357** CHURCH  
STREET

**CBRE TRIDEL**



**PREMIUM RETAIL INVESTMENT OPPORTUNITY ON CHURCH STREET**



CBRE TRIDEL

## PROPERTY OVERVIEW

CBRE Limited is pleased to offer for sale on behalf of the Vendor, The Residences of Alter Inc., a 1,429 sq. ft. retail unit on the ground floor of 357 Church Street. The Property is a retail/condominium property located at the base of a new 355-unit condominium building at Church & Carlton. Built by Tridel, one of Toronto's premier condominium developers, construction was completed in 2017. The Property is leased to A&W for 13 years, who are fully fixtured and currently open for business.

## INVESTMENT HIGHLIGHTS

- » Prime Downtown Toronto location
- » Leased to a AAA tenant
- » Triple net and fully carefree lease
- » Contractual rental escalations
- » Located steps from the TTC

**PRICE: \$1,850,000**

**OFFER DATE: WEDNESDAY NOVEMBER 25<sup>TH</sup>, 2020 AT 4:00PM**

# FLOOR PLAN

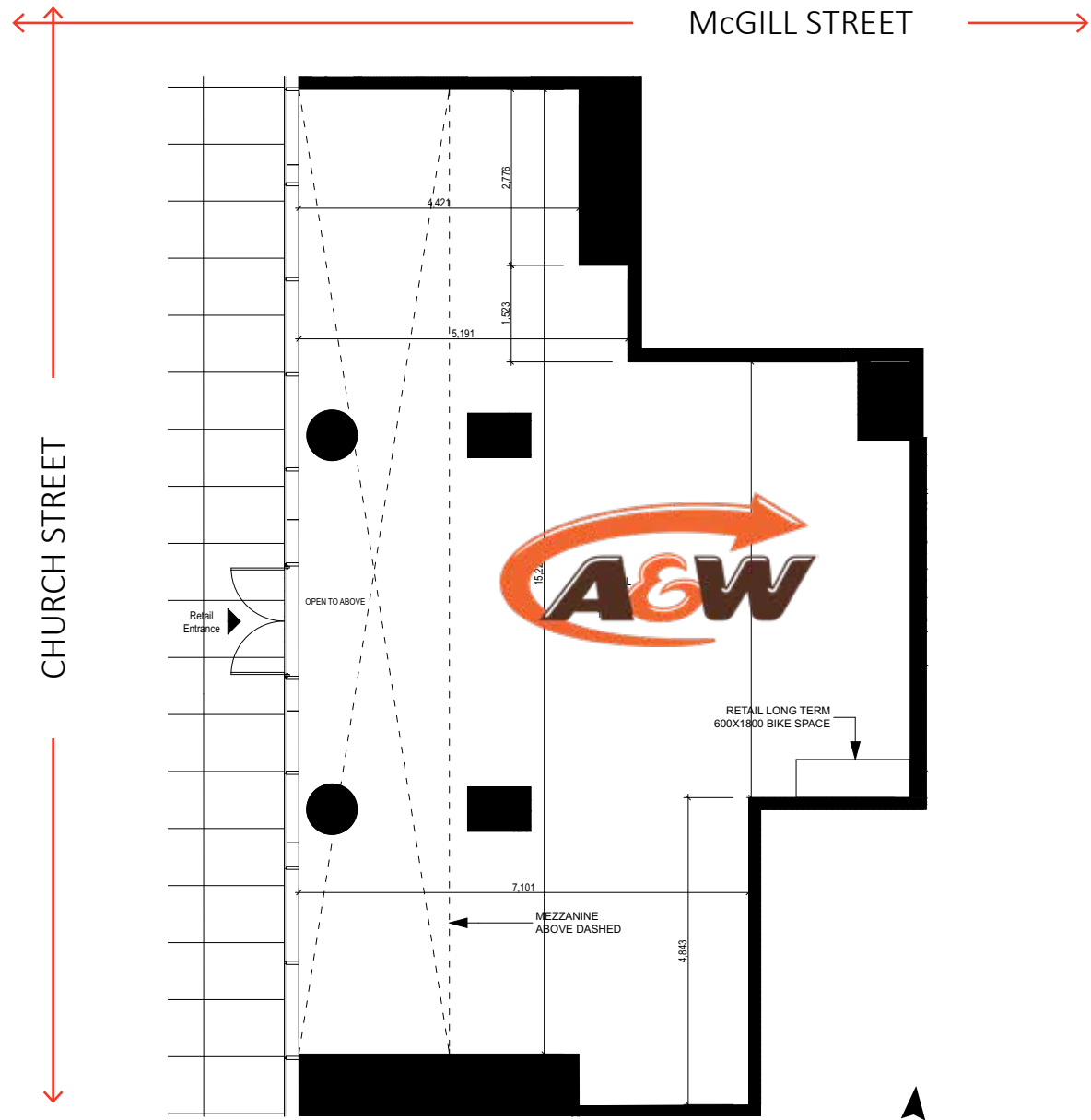

# AREA CONDO DEVELOPMENTS



	Condominium	Units/ Stories	Status
1	280 Jarvis Street	306 units 25/10 storeys	Pre-Construction
2	308 Jarvis Street	485 units 34 storeys	Pre-Construction
3	Stanley Condominiums	537 units 41 storeys	Under Construction
4	Axis Condominium	541 units 38 storeys	Under Construction
5	2 Carlton	1046 units 73 storeys	Pre-Construction
6	YSL	1106 units 85 storeys	Under Construction
7	Grid Condos	563 units 50 storeys	Complete
8	Dundas Square Gardens	1004 units 50/19 storeys	Under Construction
9	in.DE Dundas East & Jarvis Condo	205 units 21 storeys	Under Construction
10	YC Condos	639 units 62 storeys	Complete
11	Halo Residences	451 units 38 storeys	Under Construction
12	TeaHouse 501 Condominiums	608 units 52/25 storeys	Under Construction
13	Wellesley on the Park	742 units 60 storeys	Under Construction
14	VOX Condos	337 units 35 storeys	Complete
15	50 at Wellesley Station	365 units 37 storeys	Complete

	Condominium	Units/ Stories	Status
16	8 Elm	667 units 67 storeys	Pre-Construction
17	Eaton Chelsea Redevelopment	1,897 units 4 towers	Pre-Construction
18	415 Yonge Street (Rental)	450 units 61 storeys	Pre-Construction
19	475 Yonge Street	1,274 units 58/48 storeys	Pre-Construction
20	10 Wellesley St W	602 units 55 storeys	Pre-Construction
21	552 Church Street	442 units 39 storeys	Pre-Construction
22	Eighty One Wellesley	179 units 28 storeys	Under Construction
23	Prime Condos	579 units 45 storeys	Pre-Construction
24	295 Jarvis Street	351 units 36 storeys	Pre-Construction
25	159SW Condos	360 units 36 storeys	Under Construction
26	Menkes 60 Shuter Street	320 units 29 storeys	Under Construction
27	Panda Condos	555 units 30 storeys	Under Construction
28	Social Condos	598 units 52 storeys	Under Construction
29	Alter	340 units 33 storeys	Complete



**OVER 17,400 NEW CONDOMINIUM UNITS**  
under-construction or in the pre-construction  
phase in the immediate vicinity of 357 Church  
Street



## FOR MORE INFORMATION, PLEASE CONTACT

**Arlin Markowitz\***

Senior Vice President

416 815 2374

[arlin.markowitz@cbre.com](mailto:arlin.markowitz@cbre.com)

**Alex Edmison\***

Senior Vice President

416 874 7266

[alex.edmison@cbre.com](mailto:alex.edmison@cbre.com)

**Jackson Turner\*\***

Vice President

416 815 2394

[jackson.turner@cbre.com](mailto:jackson.turner@cbre.com)

**Teddy Taggart\***

Senior Sales Associate

416 847 3254

[teddy.taggart@cbre.com](mailto:teddy.taggart@cbre.com)

**Selina Tao**

Sales Representative

416 815 2396

[selina.tao@cbre.com](mailto:selina.tao@cbre.com)

\*Sales Representative, \*\*Broker

E.&O.E.

**CBRE TRIDEL**

This disclaimer shall apply to CBRE Limited, Real Estate Brokerage, and to all other divisions of the Corporation; to include all employees and independent contractors ("CBRE"). The information set out herein, including, without limitation, any projections, images, opinions, assumptions and estimates obtained from third parties (the "Information") has not been verified by CBRE, and CBRE does not represent, warrant or guarantee the accuracy, correctness and completeness of the Information. CBRE does not accept or assume any responsibility or liability, direct or consequential, for the Information or the recipient's reliance upon the Information. The recipient of the Information should take such steps as the recipient may deem necessary to verify the Information prior to placing any reliance upon the Information. The Information may change and any property described in the Information may be withdrawn from the market at any time without notice or obligation to the recipient from CBRE. CBRE and the CBRE logo are the service marks of CBRE Limited and/or its affiliated or related companies in other countries. All other marks displayed on this document are the property of their respective owners. All Rights Reserved.