

YONGE ST. CLAIR

SLATE



1 St. Clair East Retail for Lease

CBRE Limited, Real Estate Brokerage | 145 King Street West | Suite 1100 | Toronto, ON M5H 1J8 | 416 362 2244 | www.cbre.ca

CBRE



Property Highlights

SIZE:	Concourse:	431 sq. ft.- 1,796 sq. ft.
NET RENT:	Please call listing agents	
TMI:	\$20.00 per sq. ft.	
AVAILABLE:	March 1, 2021	
CEILING HEIGHTS:	Ground:	17' 11"
	Concourse:	12' 2"

- 1 St. Clair East, along with neighbouring properties, will be receiving a complete renovation and re-merchandising
- Building has direct access to the St. Clair subway station
- Ground unit has high visibility location; Pedestrian volume of 48,390 and vehicular volume of 46,586 in a 24 hour traffic count
- Concourse has excellent pedestrian volume as TTC riders must pass through to enter the station; St. Clair Station sees on average 34,610 people each weekday

Floor Plans

Ground Floor

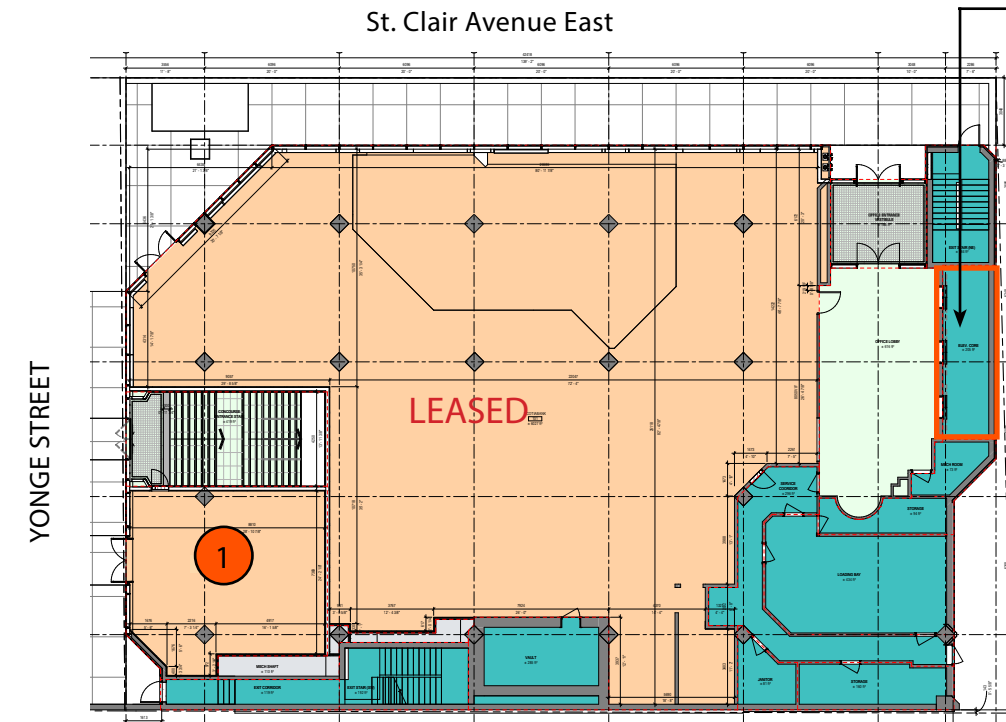

① ~~857 sq. ft.~~ LEASED!

Concourse

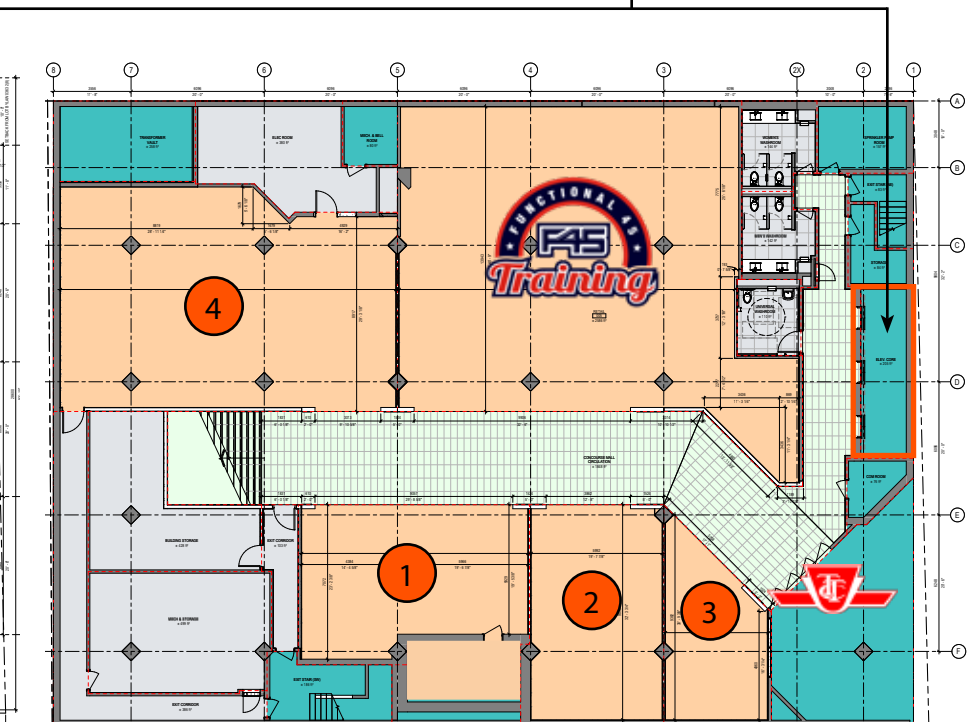

① 1,073 sq. ft. ④ 1,796 sq. ft.
 ② 716 sq. ft. ⑤ ~~2,670 sq. ft.~~ LEASED!
 ③ 431 sq. ft.

This disclaimer shall apply to CBRE Limited, Real Estate Brokerage, and to all other divisions of the Corporation; to include all employees and independent contractors ("CBRE"). The information set out herein, including, without limitation, any projections, images, opinions, assumptions and estimates obtained from third parties (the "Information") has not been verified by CBRE, and CBRE does not represent, warrant or guarantee the accuracy, correctness and completeness of the Information. CBRE does not accept or assume any responsibility or liability, direct or consequential, for the Information or the recipient's reliance upon the Information. The recipient of the Information should take such steps as the recipient may deem necessary to verify the Information prior to placing any reliance upon the Information. The Information may change and any property described in the Information may be withdrawn from the market at any time without notice or obligation to the recipient from CBRE. CBRE and the CBRE logo are the service marks of CBRE Limited and/or its affiliated or related companies in other countries. All other marks displayed on this document are the property of their respective owners. All Rights Reserved.











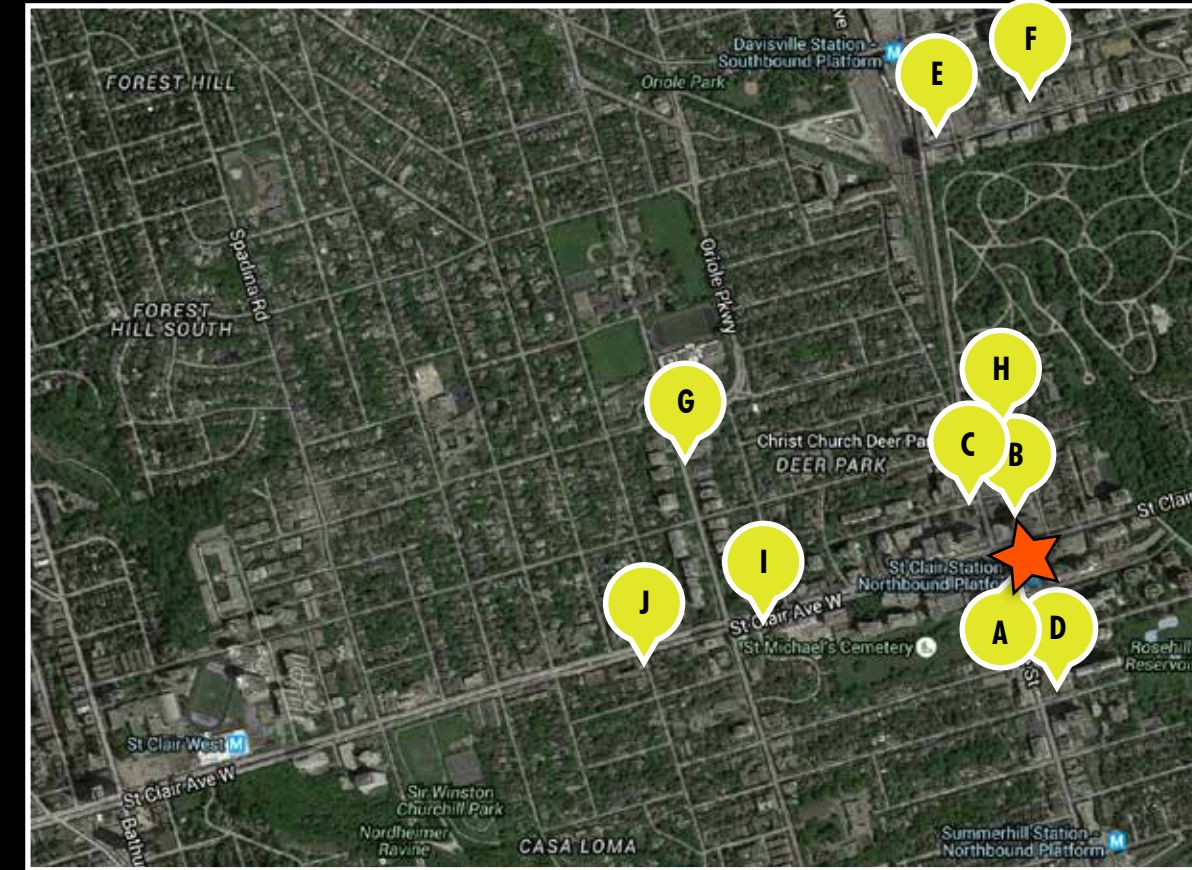

Area Overview



YONGE + ST. CLAIR

Condo Developments In the Area

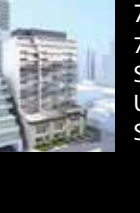

- A.**  **1421 Yonge Street**
Great Gulf & Terracap
Status: Pre-Construction
Units: 220
Storeys: 34
- B.**  **1481, 1491, 1501 Yonge St, 25, 27 & 29 Heath St**
Witington Properties
Status: Approved
Units: 470
Storeys: 37
- C.**  **1 Delisle Ave Condos**
Slate Asset Management
Status: Pre-Construction
Units: 263
Storeys: 48
- D.**  **1331 Yonge Street**
The Jack Condominiums
Status: Under Construction
Units: 153
Storeys: 11
- E.**  **Yonge & Merton St**
Cresford
Status: Complete
Storeys: 28
- F.**  **68 Merton St**
Life Condominiums
Status: Recently Complete
Units: 149
Storeys: 13
- G.**  **609 Avenue Road**
The Upper Canada Condos
Status: Under Construction
Units: 161
Storeys: 19
- H.**  **7 Heath Street**
7 Heath Street
Status: Construction
Units: 97
Storeys: 13
- I.**  **129 St. Clair Avenue West**
Blue Diamond On the Hill
Status: Under Construction
Units: 220
Storeys: 26
- J.**  **St. Clair Avenue West & Poplar Plains Road**
Status: Under Construction
Units: 166
Storeys: 11

CBRE

YONGE + ST. CLAIR

1 Delisle Avenue

Future 48-storey mixed-use building with 263 residential units by Slate Asset Management



HEATH STREET WEST



DELISLE AVENUE



YONGE STREET

HEATH STREET WEST

Midtown Gastro Hub
Harvey's
Tim Hortons



YONGE STREET

ST. CLAIR AVENUE WEST

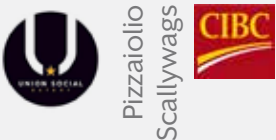

HOLYCHUCK
-Business - Burgers-
Delica Kitchen
Bagel House

The Papery
Home Hardware

NOVE TRATTORIA

Spiga Ristorante

Capocaccia

BALMORAL AVENUE



ST. CLAIR AVENUE EAST

1 ST. CLAIR AVE EAST



1421 YONGE ST
Future 34-storey mixed-use building with 220 residential units by Terracap/ Great Gulf



Aroma Espresso Bar

PLEASANT BLVD

HERO
CERTIFIED
BURGERS

ROSEHILL AVENUE

STARBUCKS

Blodry Lounge



The Future of Yonge + St.Clair

2 St. Clair Avenue West



The new 2 St. Clair West is home to a new Buca restaurant concept (opening soon) featuring a dramatic new double-height façade and an outdoor patio at grade.

2 St. Clair Avenue East



The St. Clair Centre has recently undergone a significant renovation that comprises of 90,000 sq.ft. of retail anchored by a brand new Loblaws, Rexall, TD and a new restaurant concept from Chase Hospitality Group.



CBRE

1 St. Clair Avenue East



YONGE + ST. CLAIR

Slate Portfolio
1.2 million sq.ft. of
office space with over
5,000 office tenants

Yonge Street

21 St. Clair
Ave East

1 St. Clair
Ave East

2 St. Clair
Ave East

1 St. Clair
Ave West

2 St. Clair
Ave West

30 St. Clair
Ave West

40 St. Clair
Ave West

55 St. Clair
Ave West

St. Clair East

Arlin Markowitz*
Executive Vice President
416 815 2374
arlin.markowitz@cbre.com

Alex Edmison*
Vice President
416 874 7266
alex.edmison@cbre.com

Jackson Turner**
Vice President
416 815 2394
jackson.turner@cbre.com

Teddy Taggart*
Senior Sales Associate
416 847 3254
teddy.taggart@cbre.com

*Sales Representative, **Broker