

For Lease

113 Ossington Avenue  
Toronto, ON



**hullmark**

## Salient Details

**Ground Floor:** 3,426 sq. ft.

## Key Highlights

- Fully fixtured space with front of house retail and back of house office/storage space and laneway garage door loading
- Prime retail located on Ossington Avenue in proximity to over 265,000 residents and over 5 million SF of office.
- Toronto's most electric restaurant and bar scene featuring La Banane, Mamakas, Bellwoods Brewery & Union.



## Offering

**Net Rent:** Please contact listing agents

**Additional Rent:** \$22.00 per sq. ft. (estimate for 2020)

**Availability:** Immediately

- The area is a well curated retail node with Reigning Champ, Fred Perry, Aesop, Nadege, Le Labo, gravitypop, Burton, Ollie Quinn and Tiger of Sweden as key tenants.



## Building Summary

An exceptional opportunity to occupy 3,426 square feet of retail space located on the ground level of 109OZ, a boutique condo development with 87 residential units. The area is currently experiencing significant gentrification and is home to thousands of

young and trendy professionals with above average incomes. The excellent frontage and high clear ceiling heights will give retailers an unprecedented branding opportunity on Ossington.



# Floorplan

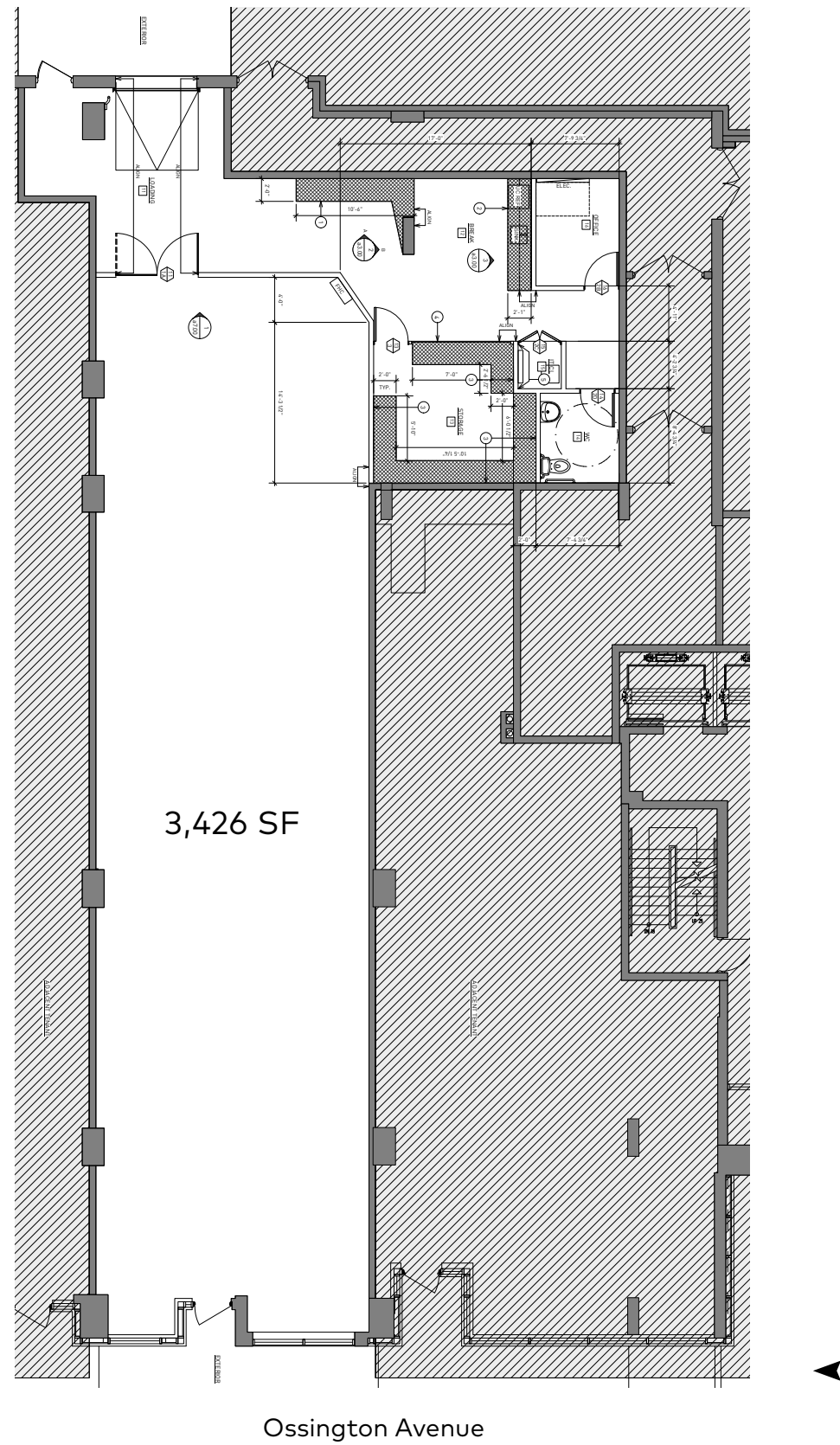



FINANCIAL CORE

DOWNTOWN WEST OFFICE/  
ENTERTAINMENT DISTRICT

LIBERTY VILLAGE

505 Dundas  
Streetcar

TRINITY BELLWOODS  
PARK

WEST QUEEN WEST

**7%**  
Population Change  
(2018-2019)



113 OSSINGTON

**257,603**  
Population

**\$113,400**  
Average Household Income

501 Queen  
Streetcar

**34.3**  
Median Age

Streetscape Map

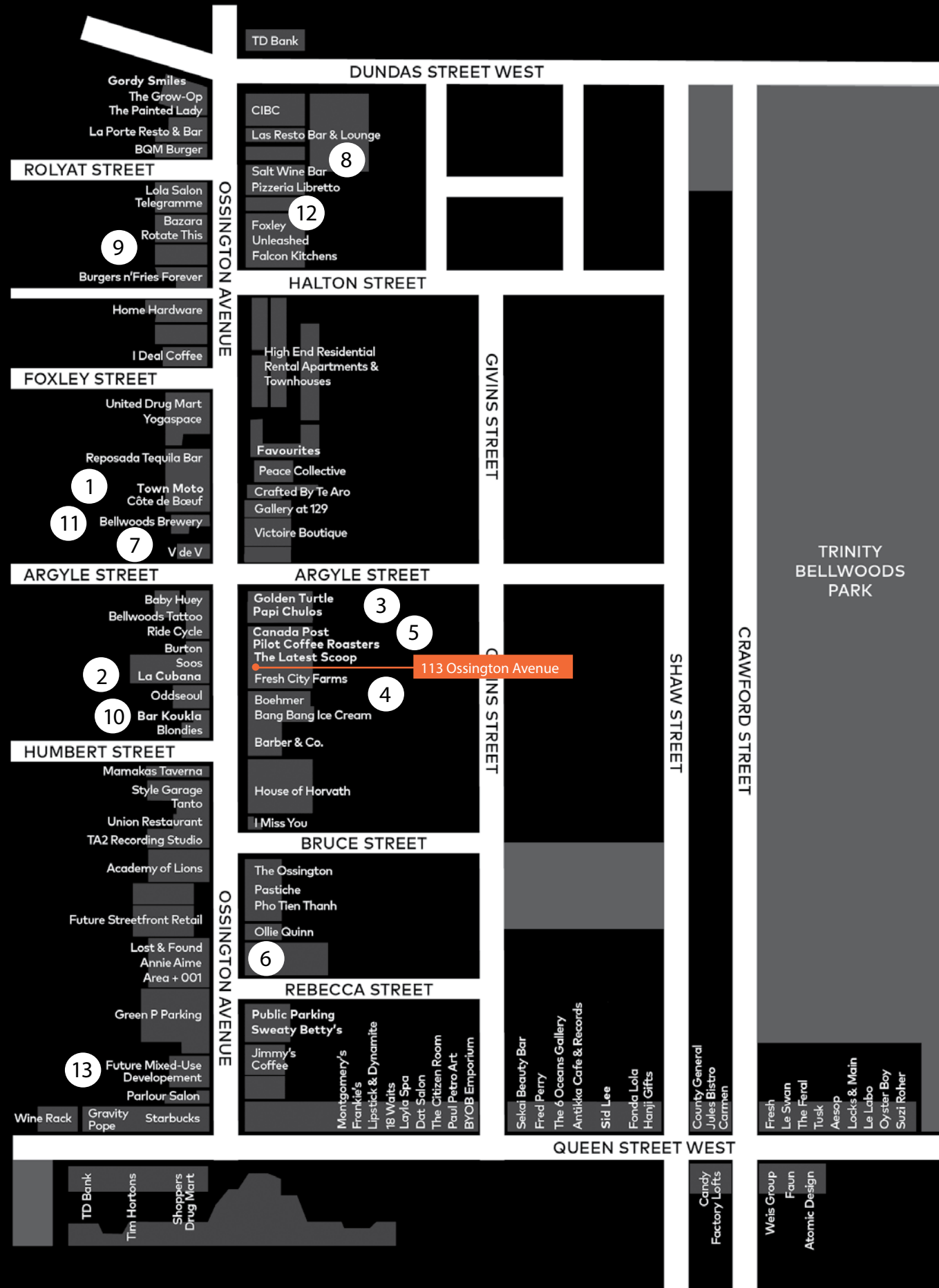

Ossington



Here Here, a neighbourhood magazine published in 2019 by Hullmark in collaboration with Public Address. They interviewed and documented the people, buildings and businesses that define the Ossington community.



1  
**Doubleknaut Design**  
 134 Ossington



3  
**Golden Turtle Restaurant**  
 125 Ossington



2  
**La Cubana**  
 92 Ossington



4  
**Muhammad Ali vs George Chuvalo**  
 109 Ossington

In March 1966, Muhammad Ali trained at 109 Ossington to fight Toronto-born George Chuvalo for the World Boxing Council heavyweight championship at Maple Leaf Gardens.



5  
**Pilot Coffee Roasters**  
 117 Ossington



6  
**Reigning Champ**  
 41 Ossington

**"Here we're made up of so many different cultures and I think that contributes to our openness to try new things."**

**Brandon Olsen**  
**La Banane**  
92 Ossington

8



7  
**V de V**  
120 Ossington

9  
**Favorites / Superpoint**  
141 & 184 Ossington



10  
**Misfitstudio**  
88 Ossington



11  
**Bellwoods Brewery**  
124 Ossington



13  
**Fire Hall No.9, 1955**  
(Courtesy of Toronto Public Library)



13  
**12 Ossington**  
Designed by Hariri Pontarini Architects

**"Ossington is an old street that carries a lot of history. History can be seen in its old brick buildings and industrial charm."**

**Gianpiero Pugliese**  
**Audax Architecture**

12

Back of House



**hullmark**

Hullmark  
474 Wellington Street West  
Toronto, ON M5V 1E3  
t: 416.510.1700  
www.hullmark.ca

**CBRE**

CBRE Limited.  
145 King Street West, Suite 1100  
Toronto, ON MH 1J8  
t: 416.362.2244  
www.cbre.ca





## Contact

**Arlin Markowitz\***

Senior Vice President

Urban Retail Team

t: 416.815.2374

[arlin.markowitz@cbre.com](mailto:arlin.markowitz@cbre.com)

**Jackson Turner\*\***

Associate Vice President

Urban Retail Team

t: 416.815.2394

[jackson.turner@cbre.com](mailto:jackson.turner@cbre.com)

**Alex Edmison\***

Senior Vice President

Urban Retail Team

t: 416.874.7266

[alex.edmison@cbre.com](mailto:alex.edmison@cbre.com)

**Teddy Taggart**

Sales Representative

Urban Retail Team

t: 416.847.3254

[teddy.taggart@cbre.com](mailto:teddy.taggart@cbre.com)

**Selina Tao**

Sales Representative

Urban Retail Team

t: 416.815.2396

[selina.tao@cbre.com](mailto:selina.tao@cbre.com)

\*Sales Representative, \*\*Broker

This disclaimer shall apply to CBRE Limited, Real Estate Brokerage, and to all other divisions of the Corporation; to include all employees and independent contractors ("CBRE"). The information set out herein, including, without limitation, any projections, images, opinions, assumptions and estimates obtained from third parties (the "Information") has not been verified by CBRE, and CBRE does not represent, warrant or guarantee the accuracy, correctness and completeness of the Information. CBRE does not accept or assume any responsibility or liability, direct or consequential, for the Information or the recipient's reliance upon the Information. The recipient of the Information should take such steps as the recipient may deem necessary to verify the Information prior to placing any reliance upon the Information. The Information may change and any property described in the Information may be withdrawn from the market at any time without notice or obligation to the recipient from CBRE. CBRE and the CBRE logo are the service marks of CBRE Limited and/or its affiliated or related companies in other countries. All other marks displayed on this document are the property of their respective owners. All Rights Reserved.