

**YONGE
ST. CLAIR**

SLATE



1470 Yonge Street Retail for Lease

CBRE Limited, Real Estate Brokerage | 145 King Street West | Suite 1100 | Toronto, ON M5H 1J8 | 416 362 2244 | www.cbre.ca

CBRE

Property Highlights

SIZE: 946 sq. ft.

NET RENT: Please call listing agents

TMI: \$25.00 per sq. ft.

AVAILABLE: Immediately

- Located on the ground floor of a 21-storey Class A office building
- Streetcar and subway access are steps away
- This site, along with neighbouring properties, have received a complete renovation and re-merchandising
- Neighbouring tenants include Buca, IQ Foods, RBC, Loblaws, Greenhouse Juice and Salon Scavo





Floor Plan

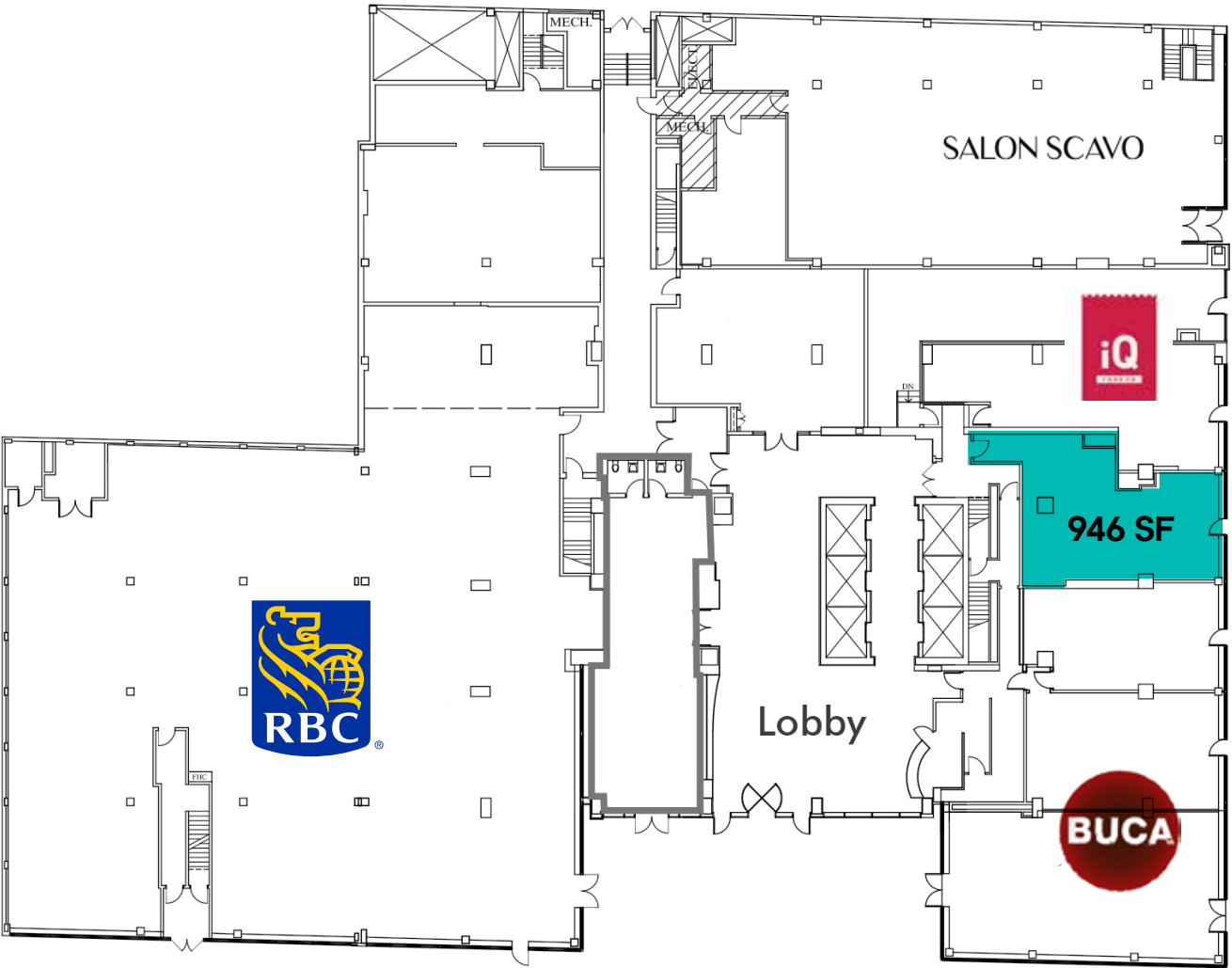

ST. CLAIR AVENUE WEST

YONGE STREET



Area Overview



Condo Developments In the Area

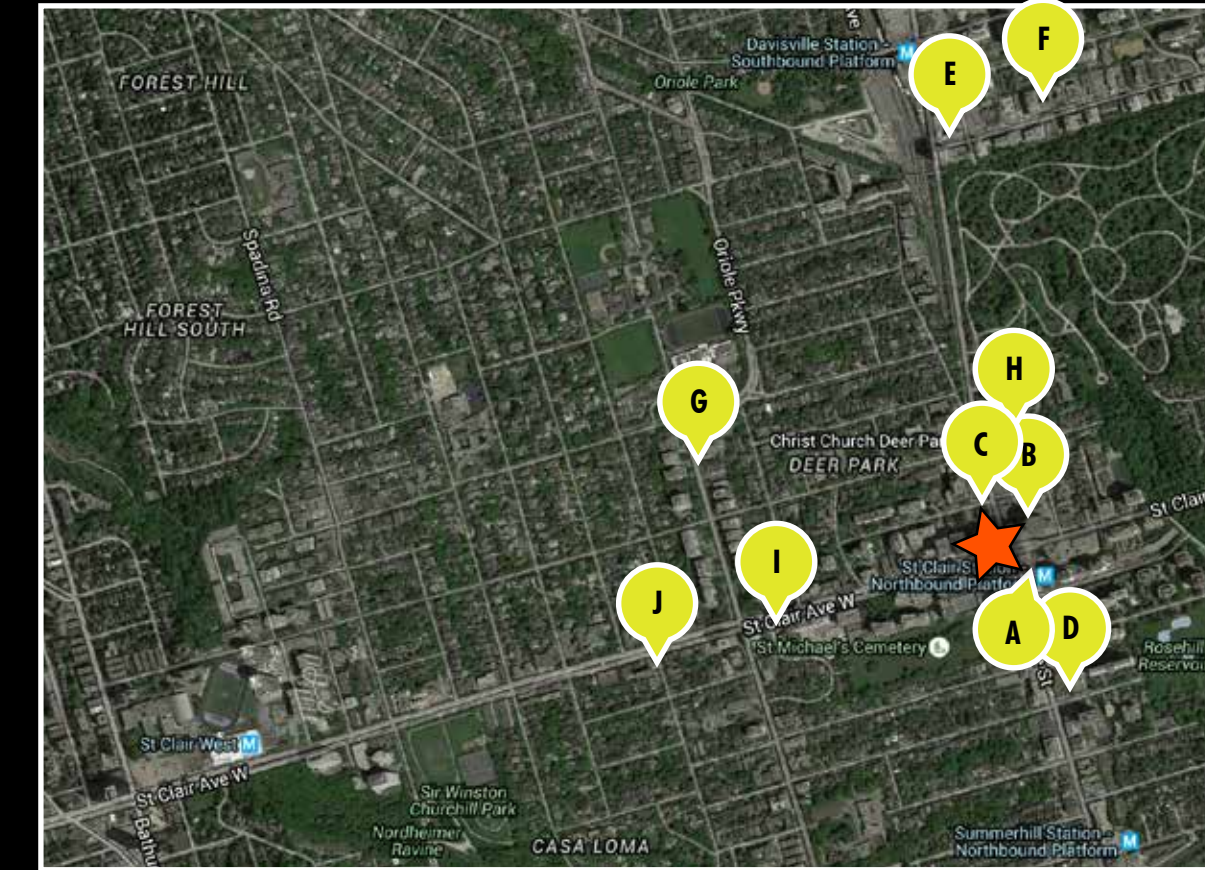

- A. 1421 Yonge Street**
Great Gulf & Terracap
Status: Pre-Construction
Units: 220
Storeys: 34
- B. 1481, 1491, 1501 Yonge St, 25, 27 & 29 Heath St**
Wittington Properties
Status: Approved
Units: 470
Storeys: 37
- C. 1 Delisle Ave Condos**
Slate Asset Management
Status: Pre-Construction
Units: 263
Storeys: 48
- D. 1331 Yonge Street**
The Jack Condominiums
Status: Under Construction
Units: 153
Storeys: 11
- E. Yonge & Merton St**
Cresford
Status: Complete
Storeys: 28
- F. 68 Merton St**
Life Condominiums
Status: Recently Complete
Units: 149
Storeys: 13
- G. 609 Avenue Road**
The Upper Canada Condos
Status: Under Construction
Units: 161
Storeys: 19
- H. 7 Heath Street**
7 Heath Street
Status: Construction
Units: 97
Storeys: 13
- I. 129 St. Clair Avenue West**
Blue Diamond On the Hill
Status: Under Construction
Units: 220
Storeys: 26
- J. St. Clair Avenue West & Poplar Plains Road**
Status: Under Construction
Units: 166
Storeys: 11

YONGE + ST. CLAIR

1 Delisle Avenue

Future 48-storey mixed-use building with 263 residential units by Slate Asset Management



DELISLE AVENUE

HEATH STREET WEST

AMBIYAN



1470 YONGE STREET



YONGE STREET

HEATH STREET WEST

Midtown Gastro Hub
Harvey's
Tim Hortons



Greenhouse Juice Co.



ST. CLAIR AVENUE WEST

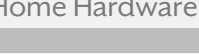
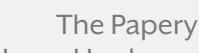
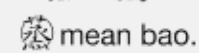
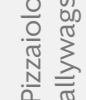

BALMORAL AVENUE



YONGE STREET

ST. CLAIR AVENUE EAST



1421 YONGE ST
Future 34-storey mixed-use building with 220 residential units by Terracap/ Great Gulf

Aroma Espresso Bar

PLEASANT BLVD



Blodry Lounge

ROSEHILL AVENUE



YONGE + ST. CLAIR

Slate Portfolio

1.2 million sq.ft. of office space with over 5,000 office tenants



Arlin Markowitz
Senior Vice President
416 815 2374
arlin.markowitz@cbre.com

Alex Edmison
Senior Vice President
416 874 7266
alex.edmison@cbre.com

Jackson Turner**
Associate Vice President
416 815 2394
jackson.turner@cbre.com

Teddy Taggart
Sales Associate
416 847 3254
teddy.taggart@cbre.com

*Sales Representative, **Broker

This disclaimer shall apply to CBRE Limited, Real Estate Brokerage, and to all other divisions of the Corporation; to include all employees and independent contractors ("CBRE"). The information set out herein, including, without limitation, any projections, images, opinions, assumptions and estimates obtained from third parties (the "Information") has not been verified by CBRE, and CBRE does not represent, warrant or guarantee the accuracy, correctness and completeness of the Information. CBRE does not accept or assume any responsibility or liability, direct or consequential, for the Information or the recipient's reliance upon the Information. The recipient of the Information should take such steps as the recipient may deem necessary to verify the Information prior to placing any reliance upon the Information. The Information may change and any property described in the Information may be withdrawn from the market at any time without notice or obligation to the recipient from CBRE. CBRE and the CBRE logo are the service marks of CBRE Limited and/or its affiliated or related companies in other countries. All other marks displayed on this document are the property of their respective owners. All Rights Reserved.