

21- WELLESLEY

**YONGE &
WELLESLEY**
WELLESLEY ON THE PARK

PRIME RETAIL FOR LEASE



Prime retail opportunity located in the heart of Toronto, between Yonge and Bay on Wellesley, overlooking a lush and abundant city park

21 WELLESLEY STREET WEST RETAIL FOR LEASE

SIZE: 7,718 sq. ft. (divisible)

NET RENT: Please contacting listing agents

TMI: \$23.00 per sq. ft. (est.)

AVAILABLE: Immediately

- All units have signature patios fronting onto a public park
- Abundant public parking under the building
- Massive ceiling heights
- Located at the base of a signature 61 storey condominium



THE LOCATION

Centrally located on Wellesley Street between Yonge and Bay, steps from the Wellesley subway station and within walking distance to both Bloor Street West and College Street stations.

The space benefits from it's close proximity to both the University of Toronto Campus, and the MaRS Discovery District- one of the world's largest urban innovation hubs employing over 5,000 people.



Walk Score
99



Transit Score
100



Princess Margaret Cancer Centre UHN
MOUNT SINAI HOSPITAL
UNIVERSITY AVENUE

MaRS DISCOVER DISTRICT
UHN Toronto General Hospital
SickKids
CIBC

WINNERS
FOOD COURT
BMO
RBC ROYAL BANK
REDS WINE TAVERN

RYERSON UNIVERSITY
STARBUCKS
REXALL

GERRARD STREET
SHOPPERS DRUG MART

CHELSEA HOTEL

GERRARD STREET
YSL RESIDENCES

LEGISLATIVE ASSEMBLY OF ONTARIO

YONGE & WELLESLEY
WELLESLEY ON THE PARK

YMCA
RBC

SCOTIABANK
TIM HORTONS
LCBO
LAN TERRA TEAHOUSE CONDO
MATTAMY ATHLETIC CENTRE
LOBLAWS FLAGSHIP
LCBO/JOE FRESH

UNIVERSITY OF TORONTO
QUEEN'S PARK

AROMA ESPRESSO BAR
TIM HORTONS
MERIDIAN CREDIT UNION

LAN TERRA BRITT CONDO
AROMA

CHARLES STREET EAST
WISH
HONE FITNESS
STARBUCKS

YORKVILLE
BLOOR STREET WEST
CHARLES STREET WEST

GOODLIFE FITNESS
EATALY
APPLE STORE (FUTURE)

HUDSON BAY
NORDSTROM RACK
MCEWAN'S GROCERY
SPRING ROLLS
STARBUCKS

FLOOR PLAN 7,718 SF

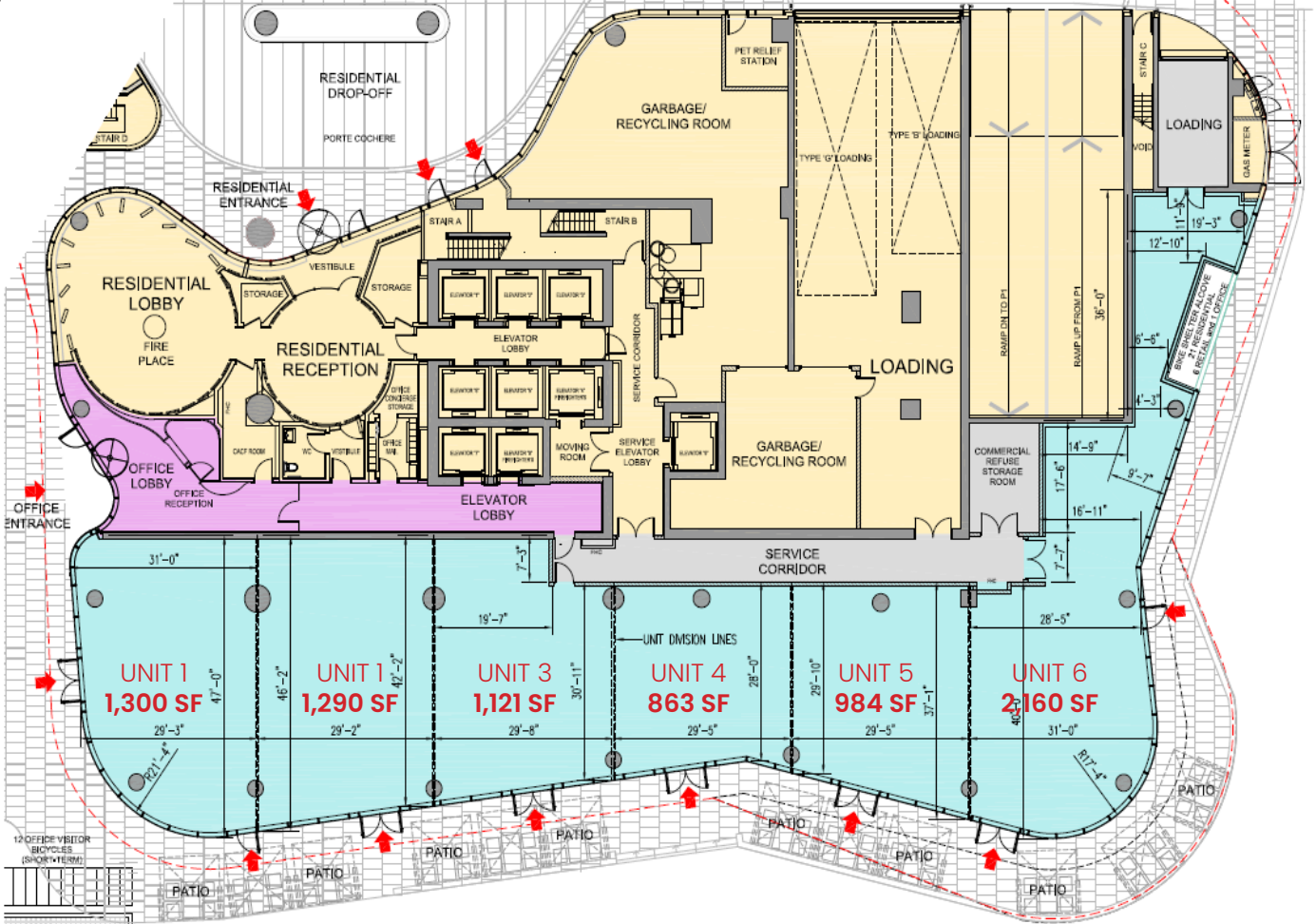



ADVISORS

Arlin Markowitz*
Senior Vice President
416 815 2374
arlin.markowitz@cbre.com

Alex Edmison*
Senior Vice President
416 874 7266
alex.edmison@cbre.com

Jackson Turner**
Associate Vice President
416 815 2394
jackson.turner@cbre.com

Teddy Taggart*
Sales Associate
416 847 3254
teddy.taggart@cbre.com

Selina Tao
Sales Representative
416 815 2396
selina.tao@cbre.com

*Sales Representative
**Broker

CBRE

This disclaimer shall apply to CBRE Limited, Real Estate Brokerage, and to all other divisions of the Corporation; to include all employees and independent contractors ("CBRE"). The information set out herein, including, without limitation, any projections, images, opinions, assumptions and estimates obtained from third parties (the "Information") has not been verified by CBRE, and CBRE does not represent, warrant or guarantee the accuracy, correctness and completeness of the Information. CBRE does not accept or assume any responsibility or liability, direct or consequential, for the Information or the recipient's reliance upon the Information. The recipient of the Information should take such steps as the recipient may deem necessary to verify the Information prior to placing any reliance upon the Information. The Information may change and any property described in the Information may be withdrawn from the market at any time without notice or obligation to the recipient from CBRE. CBRE and the CBRE logo are the service marks of CBRE Limited and/or its affiliated or related companies in other countries. All other marks displayed on this document are the property of their respective owners. All Rights Reserved.