

SLATE

YONGE +  
ST. CLAIR



# 55 St. Clair West Retail for Lease

CBRE Limited, Real Estate Brokerage | 145 King Street West | Suite 1100 | Toronto, ON M5H 1J8 | 416 362 2244 | [www.cbre.ca](http://www.cbre.ca)



# Property Highlights

**SIZE:** 8,100 sq. ft. + 5,000 sq. ft. outdoor area

**NET RENT:** Please call listing agents

**TMI:** \$23.76 per sq. ft. (2021 est.)

**AVAILABLE:** Q1 2022

- Located on the ground floor of a 9-storey office building
- Features a rare large outdoor/playground area (5,000 sq. ft.)
- Streetcar and subway access are steps away
- Next to the entrance to an underground public parking lot with 200 spaces
- Neighbouring tenants include Mary Be Kitchen, Rolex Head Office, Union Social Eatery, Presse Cafe, Buca, IQ Foods, RBC



## FLOOR PLAN

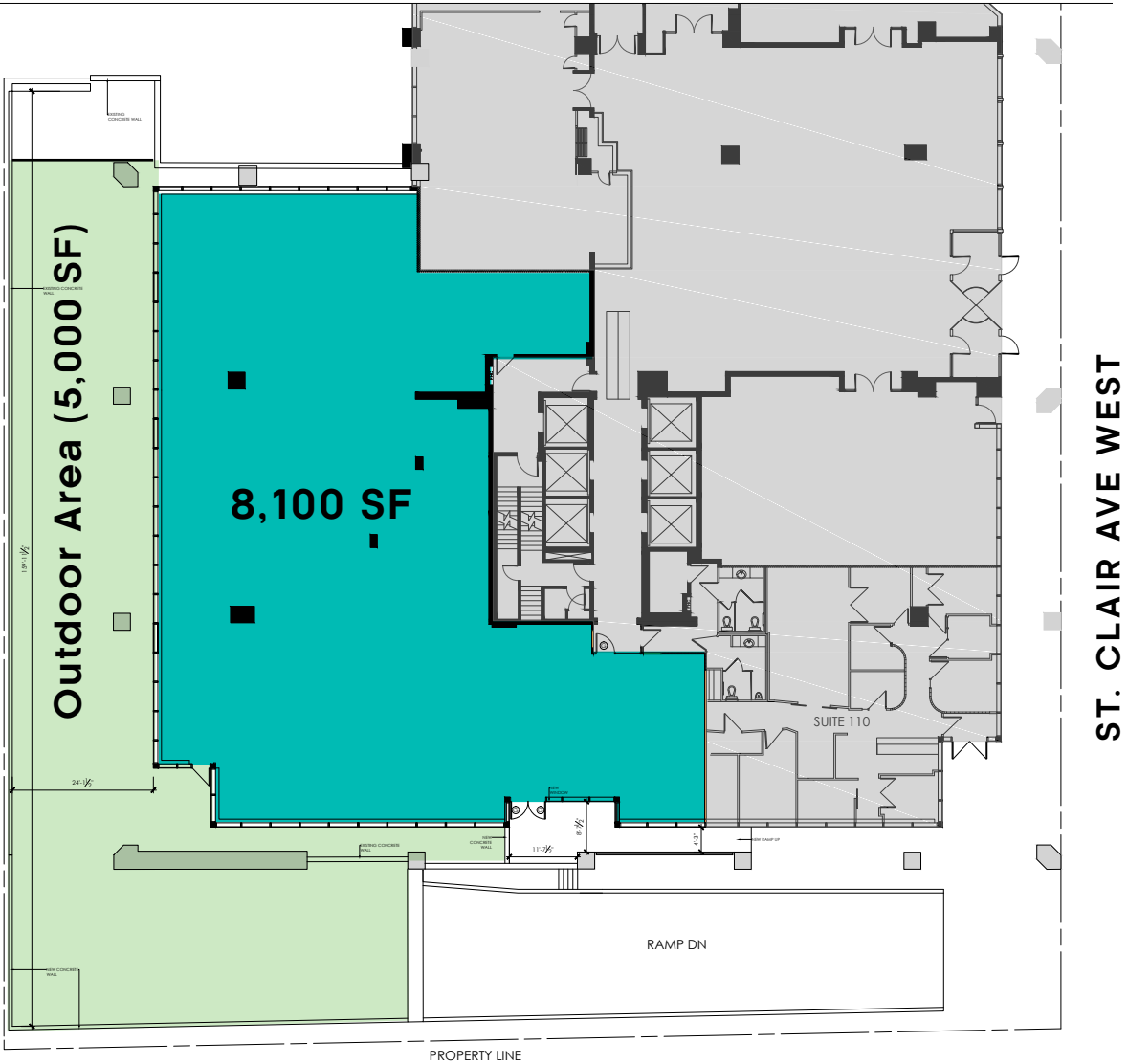



## Area Overview

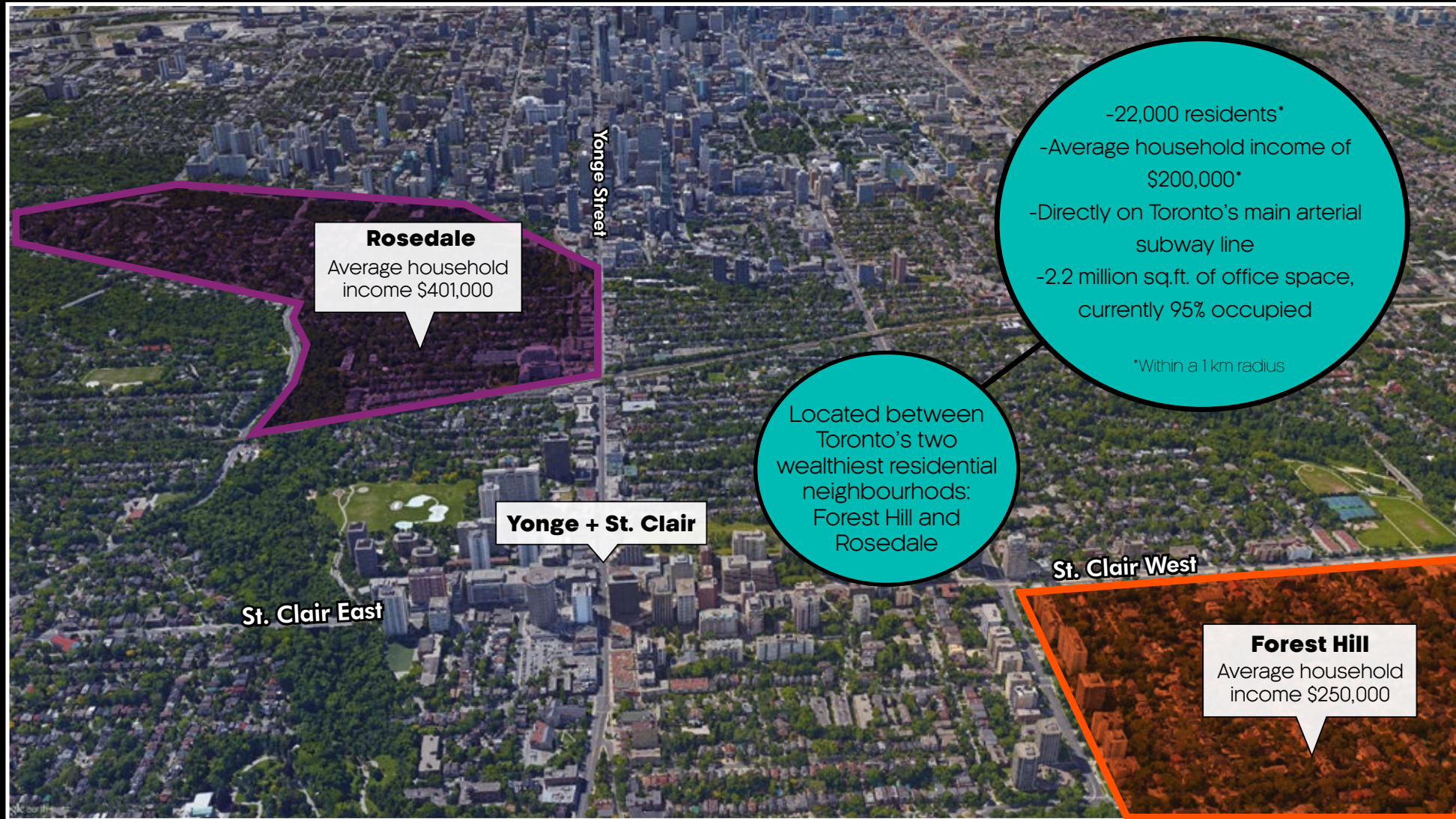

# YONGE + ST. CLAIR

## Condo Developments In the Area

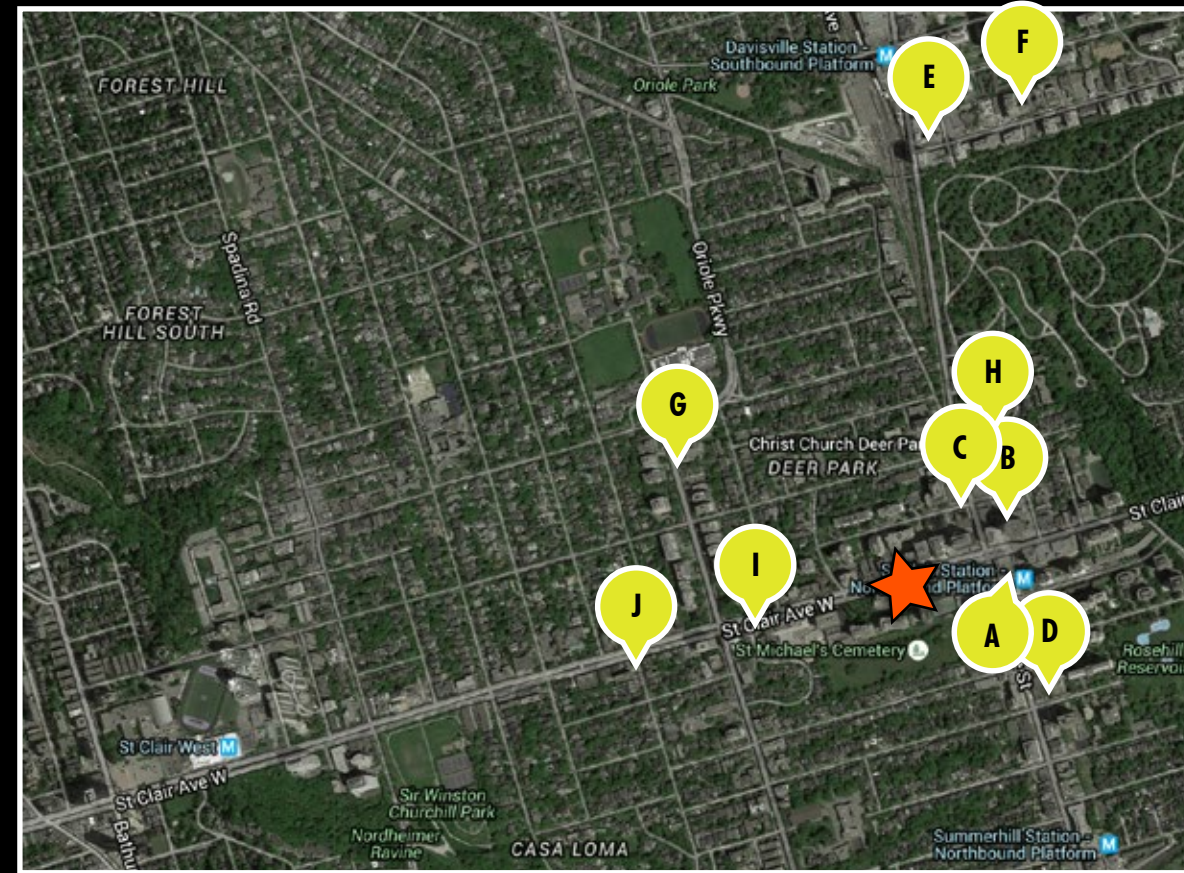

- |   |   |   |
|---|---|---|
| <p><b>E.</b></p>  <p><b>Yonge &amp; Merton St</b><br/>Cresford<br/>Status: Complete<br/>Storeys: 28</p>                  | <p><b>F.</b></p>  <p><b>68 Merton St</b><br/>Life Condominiums<br/>Status: Recently Complete<br/>Units: 149<br/>Storeys: 13</p>                      | <p><b>G.</b></p>  <p><b>609 Avenue Road</b><br/>The Upper Canada Condos<br/>Status: Under Construction<br/>Units: 161<br/>Storeys: 19</p>    |
| <p><b>H.</b></p>  <p><b>7 Heath Street</b><br/>7 Heath Street<br/>Status: Construction<br/>Units: 97<br/>Storeys: 13</p> | <p><b>I.</b></p>  <p><b>129 St. Clair Avenue West</b><br/>Blue Diamond On the Hill<br/>Status: Under Construction<br/>Units: 220<br/>Storeys: 26</p> | <p><b>J.</b></p>  <p><b>St. Clair Avenue West &amp; Poplar Plains Road</b><br/>Status: Under Construction<br/>Units: 166<br/>Storeys: 11</p> |

**CBRE**



# YONGE + ST. CLAIR

**HEATH STREET WEST**

**One Delisle**  
Future 47- luxury residential building with 383 residential units by Slate Asset Management

**DELISLE AVENUE**

Kwan Dim Sum  
**MODO YOGA**  
**iQ**  
**FIORIO**  
**BUCA**

**ROLEX** HEAD OFFICE  
Deaco Sushi  
PRESSED CAFE  
RBC

**AMBIYAN**  
on Yonge  
**freshii**  
**BMO**

**HEATH STREET WEST**

Midtown Gastro Hub  
Tim Hortons  
**SHOPPERS DRUG MART**

**Loblaws**  
Greenhouse Juice Co.  
**STARBUCKS**  
**TD** **Rexall**  
**ARTHUR'S** RESTAURANT  
**GoodLife FITNESS**

**ST. CLAIR AVENUE WEST**

**LCBO** **Longo's** **PASTA PRONTA** **Tim Hortons** **MARY BE KITCHEN** **U** **Kia's** Pizzaiolo Scallywags **CIBC**

**55 ST. CLAIR AVE WEST**

**HOLY CHUCK** - Business - Burgers!  
**mean bao.**  
**THE Bagel House**  
**NOVE TRATTORIA**  
Spiga Ristorante  
Capocaccia

**BALMORAL AVENUE**

**BARNSTEINER'S**

St. Michael's Cemetery

**ST. CLAIR AVENUE EAST**

**Scotiabank** **PS** **PLAYA CABANA**

**1421 YONGE ST**  
Future 34-storey mixed-use building with 220 residential units by Terracap/ Great Gulf

**Aroma Espresso Bar**

**PLEASANT BLVD**

**HERO CERTIFIED BURGERS**

**ROSEHILL AVENUE**

**STARBUCKS**  
Blodry Lounge  
**TERRONI**

Balfour Park







# YONGE + ST. CLAIR

## Slate Portfolio

1.2 million sq.ft. of  
office space with over  
5,400 office tenants

21 St. Clair  
Ave East

1 St. Clair  
Ave East

2 St. Clair  
Ave East

1 St. Clair  
Ave West

2 St. Clair  
Ave West

30 St. Clair  
Ave West

40 St. Clair  
Ave West

55 St. Clair  
Ave West

St. Clair East

**Arlin Markowitz\***  
Executive Vice President  
416 815 2374  
arlin.markowitz@cbre.com

**Alex Edmison\***  
Senior Vice President  
416 874 7266  
alex.edmison@cbre.com

**Jackson Turner\*\***  
Vice President  
416 815 2394  
jackson.turner@cbre.com

**Teddy Taggart\***  
Senior Sales Associate  
416 847 3254  
teddy.taggart@cbre.com

\*Sales Representative, \*\*Broker

This disclaimer shall apply to CBRE Limited, Real Estate Brokerage, and to all other divisions of the Corporation; to include all employees and independent contractors ("CBRE"). The information set out herein, including, without limitation, any projections, images, opinions, assumptions and estimates obtained from third parties (the "Information") has not been verified by CBRE, and CBRE does not represent, warrant or guarantee the accuracy, correctness and completeness of the Information. CBRE does not accept or assume any responsibility or liability, direct or consequential, for the Information or the recipient's reliance upon the Information. The recipient of the Information should take such steps as the recipient may deem necessary to verify the Information prior to placing any reliance upon the Information. The Information may change and any property described in the Information may be withdrawn from the market at any time without notice or obligation to the recipient from CBRE. CBRE and the CBRE logo are the service marks of CBRE Limited and/or its affiliated or related companies in other countries. All other marks displayed on this document are the property of their respective owners. All Rights Reserved.