

Prime Retail for Lease

Sixty Bathurst Street



1,455 sq. ft. + Patio with Excellent Frontage onto Bathurst Street

Property Details

Size: 1,455 sq. ft.

Net Rent: \$45.00 per sq. ft.

Additional Rent: \$18.06 per sq. ft.

Available: Immediately

- Fully fixtured unit, move in ready
- High pedestrian and vehicular traffic
- Great exposure across the street from the future 1 Hotel Toronto (former Thompson Hotel)
- Massive amounts of residential developments in the immediate area
- Includes 400 sq. ft. patio
- Commercial parking on-site



CBRE

Floor Plan

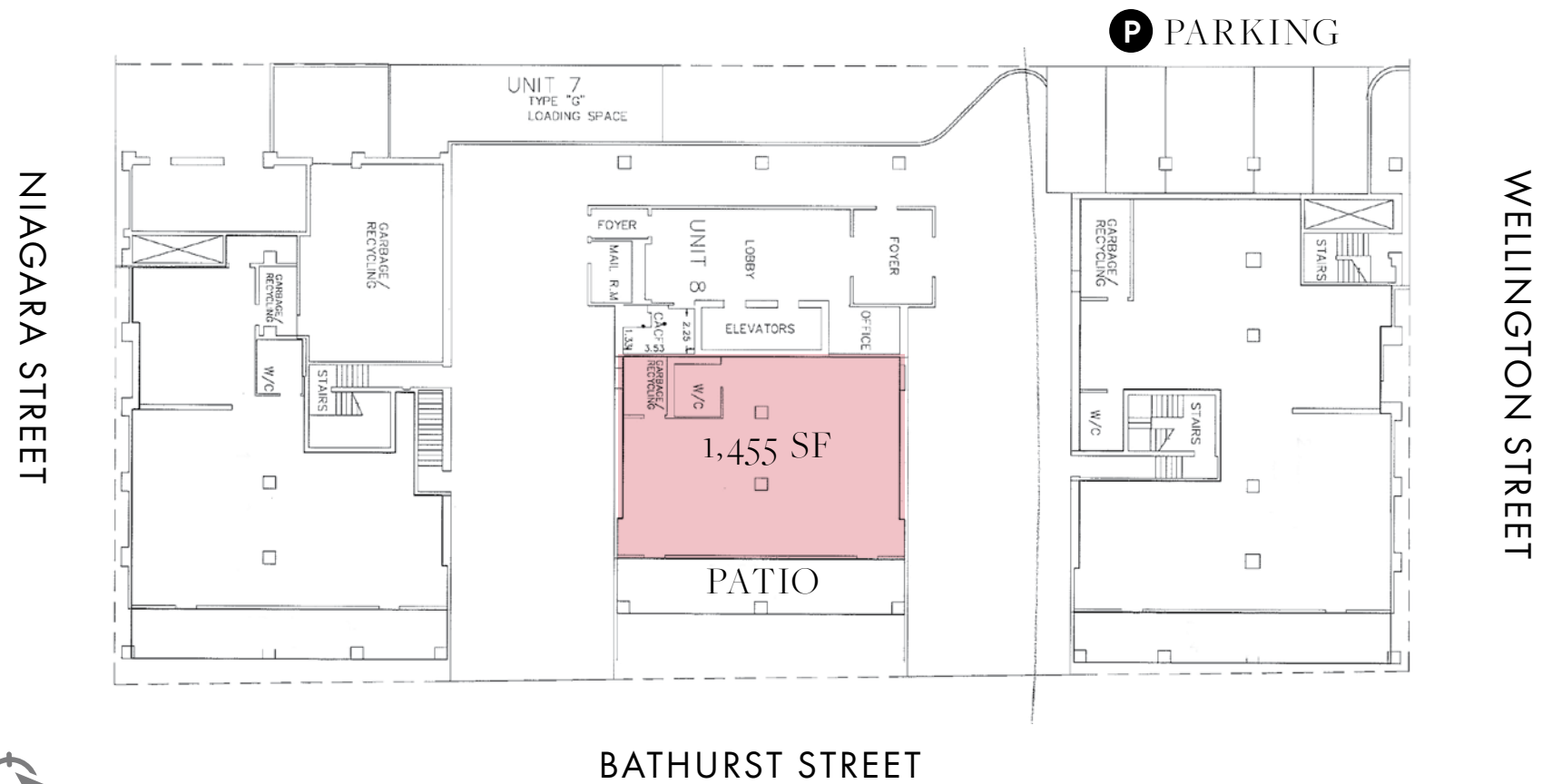

Location

60 Bathurst Street is located in the heart of Downtown West, just steps off the best stretch of shops and restaurants of King Street West including Lavelle, Oretta, Patria, and Wilbur Mexicana. Across the street is The Thompson Hotel which will continue operating until renovation for the future 1 Hotel Toronto begins, as part of the 1 Hotel's brand of high-end luxury sustainable hotels. Area traffic generators include the popular Stackt Market and Farm Boy, both of which are located a stone throw away.

60 Bathurst benefits from very high vehicular traffic and its proximity to a large number of condominium developments currently proposed and under construction, most notably downtown Toronto's largest mixed-use development The Well.



280,398
Population*



34
Median Age*



\$104,528
Avg. Household Income

*2019 statistics within 3km radius of subject property



Aerial



Area Developments

9,600 + new units

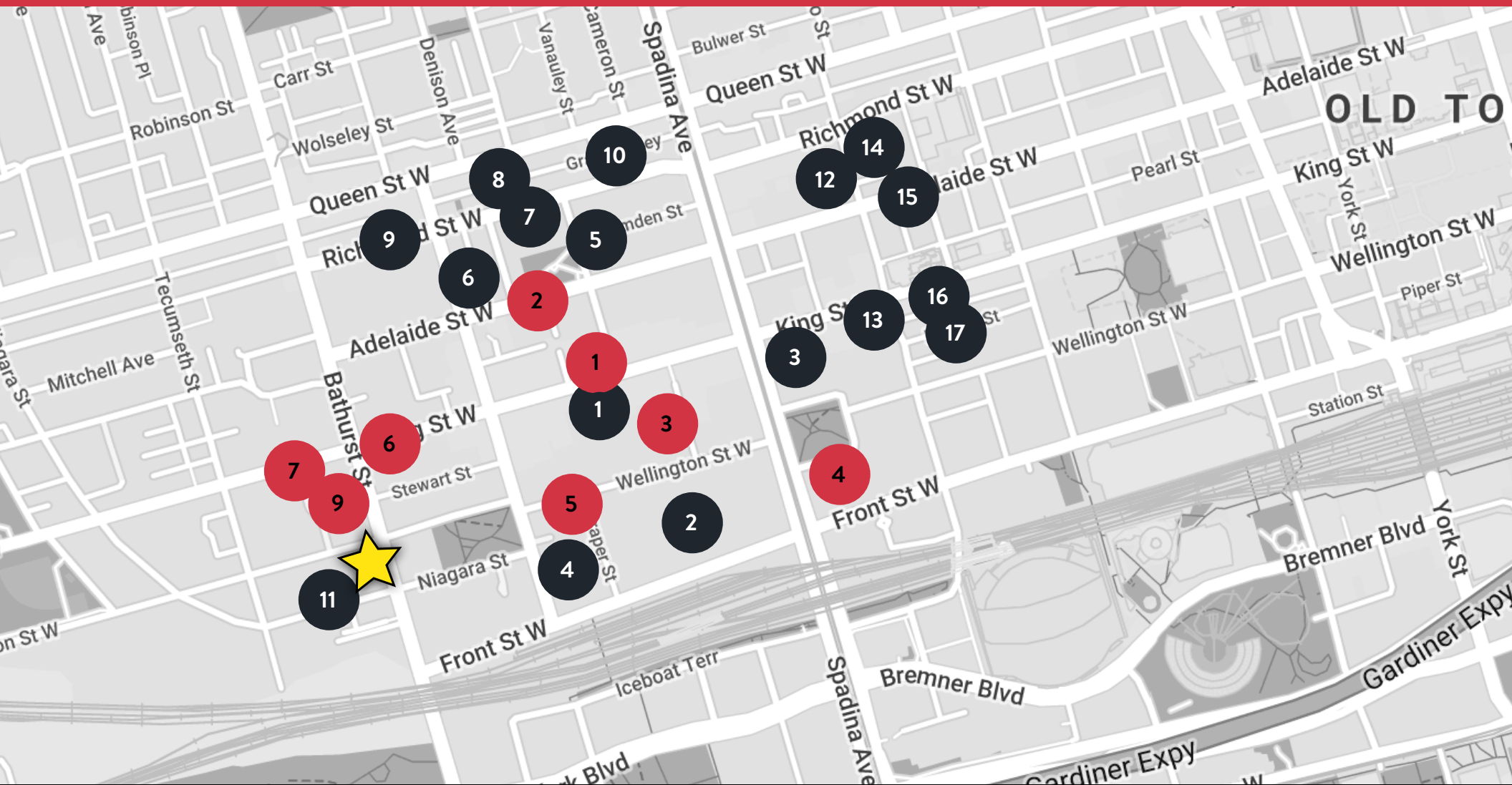

NOTABLE ACTIVE DEVELOPMENTS

#	NAME/ADDRESS	CATEGORY	STOREYS	# OF UNITS
1	KING Toronto	Condo, Retail	16	514
2	The Well	Condo, Office, Retail	36,46,39,22, 16,155, 14	1,700
3	The Taylor	Condo, Office, Retail	36	286
4	Portland Commons	Office, Retail	15	-
5	Ace Hotel	Hotel	13	-
6	123 Portland	Condo, Retail	14	117
7	Waterworks	Condo, Retail	13	299
8	Rush Condos	Condo, Retail	15	125
9	543 Richmond St W	Condo, Retail	15	476
10	The Woodsworth	Condo, Retail	17	130
11	West Condos	Condo, Retail	14,12	320
12	Peter and Adelaide	Condo, Retail	47	969
13	357 King Street West	Condo, Retail	42	342
14	Central Condos	Condo	45	426
15	Theatre District Residence	Condo, Retail, Hotel	48,49	131
16	Maverick	Condo, Retail	49	328
17	Nobu Residences	Condo, Retail, Hotel	45, 45	696

NOTABLE DEVELOPMENT APPLICATIONS

#	NAME/ADDRESS	CATEGORY	STOREYS	# OF UNITS
1	540 King Street West	Condo, Retail, Office	15	95
2	Hudson Hotel	Hotel	14	-
3	Wellington House	Condo, Retail	17	104
4	400 Front Street	Condo, Retail	63, 61, 28	2,226
5	485 Wellington Street	Condo, Retail	14	117
6	663 King Street West	Condo, Retail	17	286
7	689 King Street West	Hotel	18	-
8	580 King Street West	Office, Retail	9	-
9	64-86 Bathurst Street	Condo, Retail, Office	20	tbd

CBRE





Contact

Arlin Markowitz*
 Executive Vice President
 416 815 2374
arlin.markowitz@cbre.com

Alex Edmison*
 Senior Vice President
 416 874 7266
alex.edmison@cbre.com

Jackson Turner**
 Vice President
 416 815 2394
jackson.turner@cbre.com

Teddy Taggart*
 Senior Sales Associate
 416 847 3254
teddy.taggart@cbre.com

* Sales Representative ** Broker

This disclaimer shall apply to CBRE Limited, Real Estate Brokerage, and to all other divisions of the Corporation; to include all employees and independent contractors ("CBRE"). The information set out herein, including, without limitation, any projections, images, opinions, assumptions and estimates obtained from third parties (the "Information") has not been verified by CBRE, and CBRE does not represent, warrant or guarantee the accuracy, correctness and completeness of the Information. CBRE does not accept or assume any responsibility or liability, direct or consequential, for the Information or the recipient's reliance upon the Information. The recipient of the Information should take such steps as the recipient may deem necessary to verify the Information prior to placing any reliance upon the Information. The Information may change and any property described in the Information may be withdrawn from the market at any time without notice or obligation to the recipient from CBRE. CBRE and the CBRE logo are the service marks of CBRE Limited and/or its affiliated or related companies in other countries. All other marks displayed on this document are the property of their respective owners. All Rights Reserved.