

STREET LEVEL RETAIL FOR LEASE AT BLOOR & SHERBOURNE | TORONTO

# 365 Bloor East

At Postmedia Place

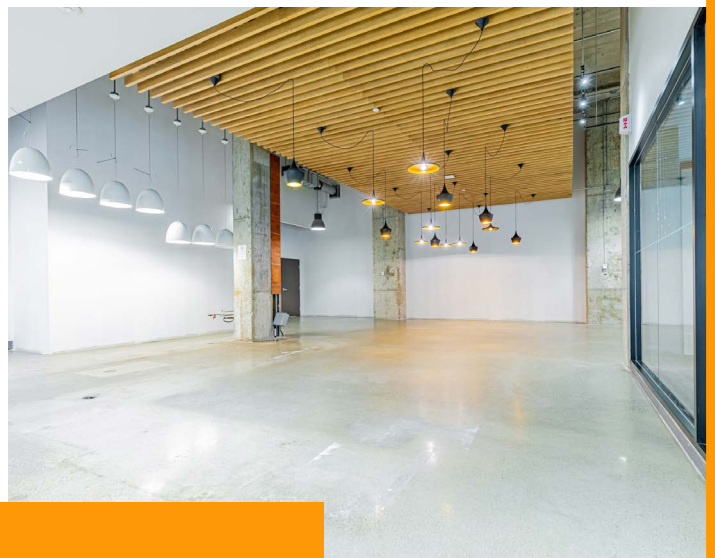

CBRE urban retail team





365 Bloor Street East, Toronto

# Property Overview

- Size:**

Entire Space: 4,178 sq. ft.  
Demised Option: 1,750 sq. ft.
- Rent:**

Entire Space: \$15.00 per s.q ft.  
Demised Option: \$30.00 per sq. ft.
- TMI:**

\$23.23 per sq. ft.
- Available:**

Contact listing agents to discuss
- Ability to lease the entire space of 4,178 SF or a demised option of 1,750 SF
  - Prime retail opportunity in the heart of Toronto on the ground level of Postmedia Place
  - This ground floor space offers exceptional visibility and foot traffic at the bustling intersection of Bloor and Sherbourne
  - Located in a mixed-use area, the unit is ideal for a wide range of retail uses including health & beauty, service-related, or food and hospitality
  - Steps from Sherbourne subway station and surrounded by high-density residential and office towers, this location ensures consistent customer flow







# Floor Plan - 4,178 SF

# Retail Site Plan

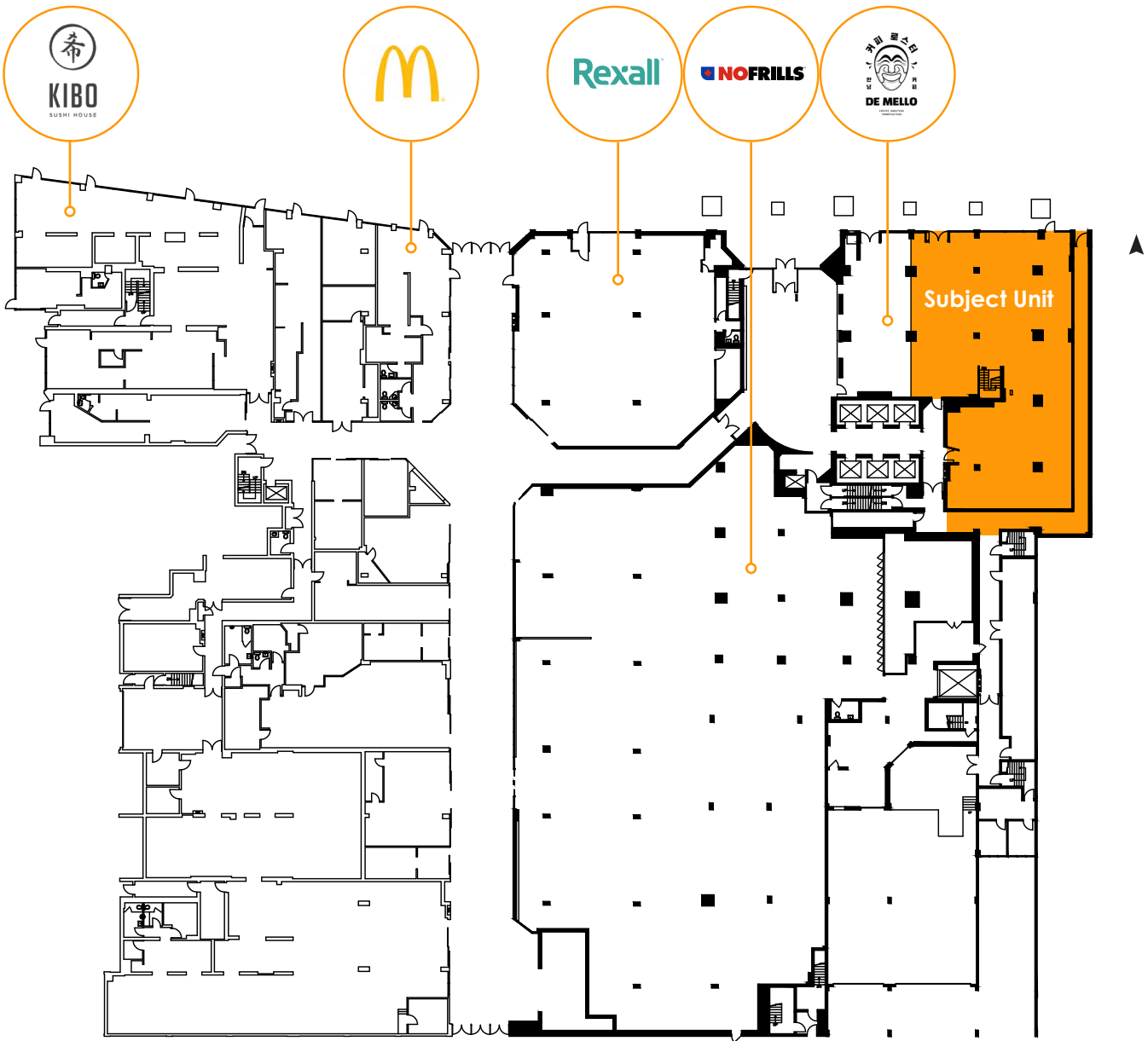
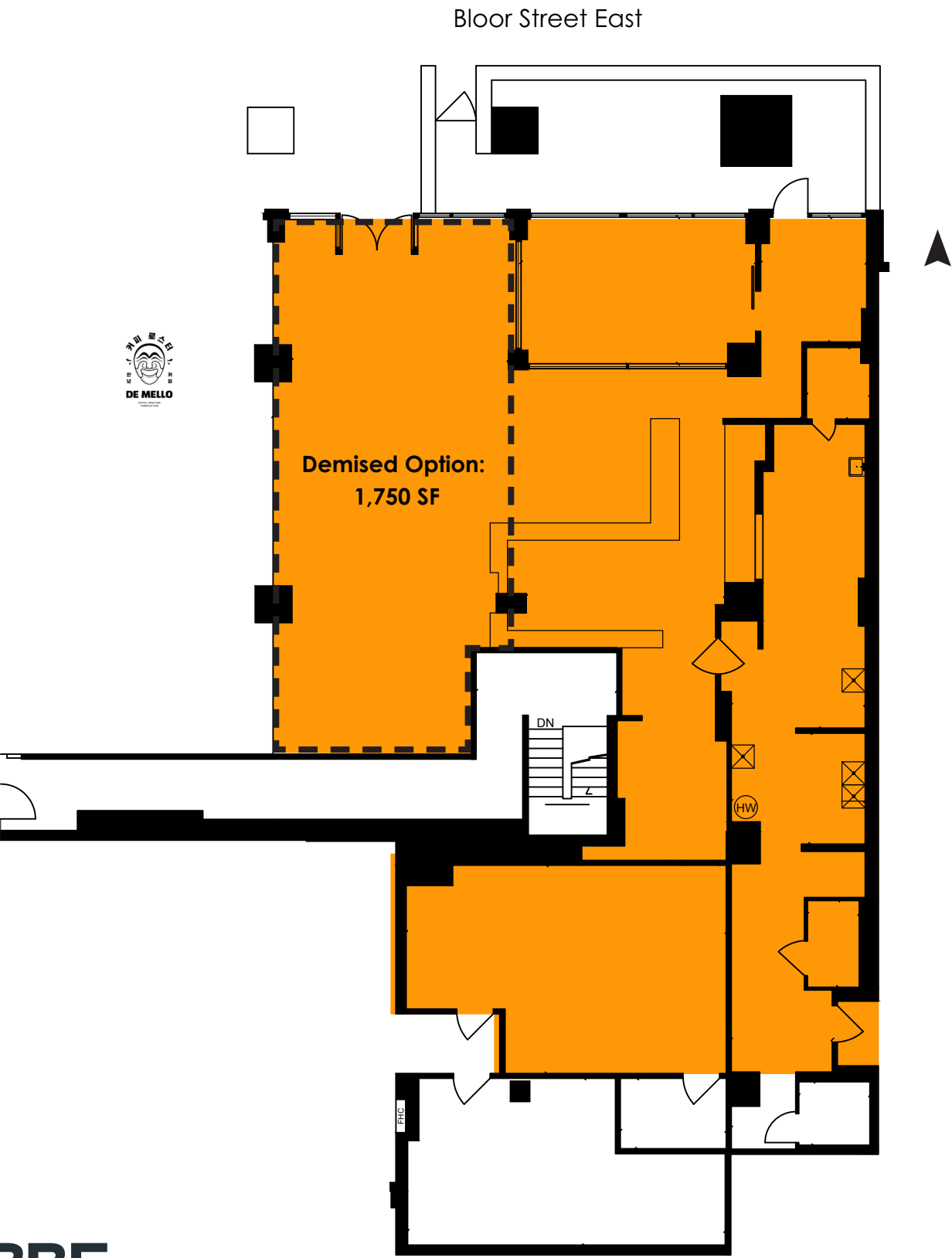



# Location Overview

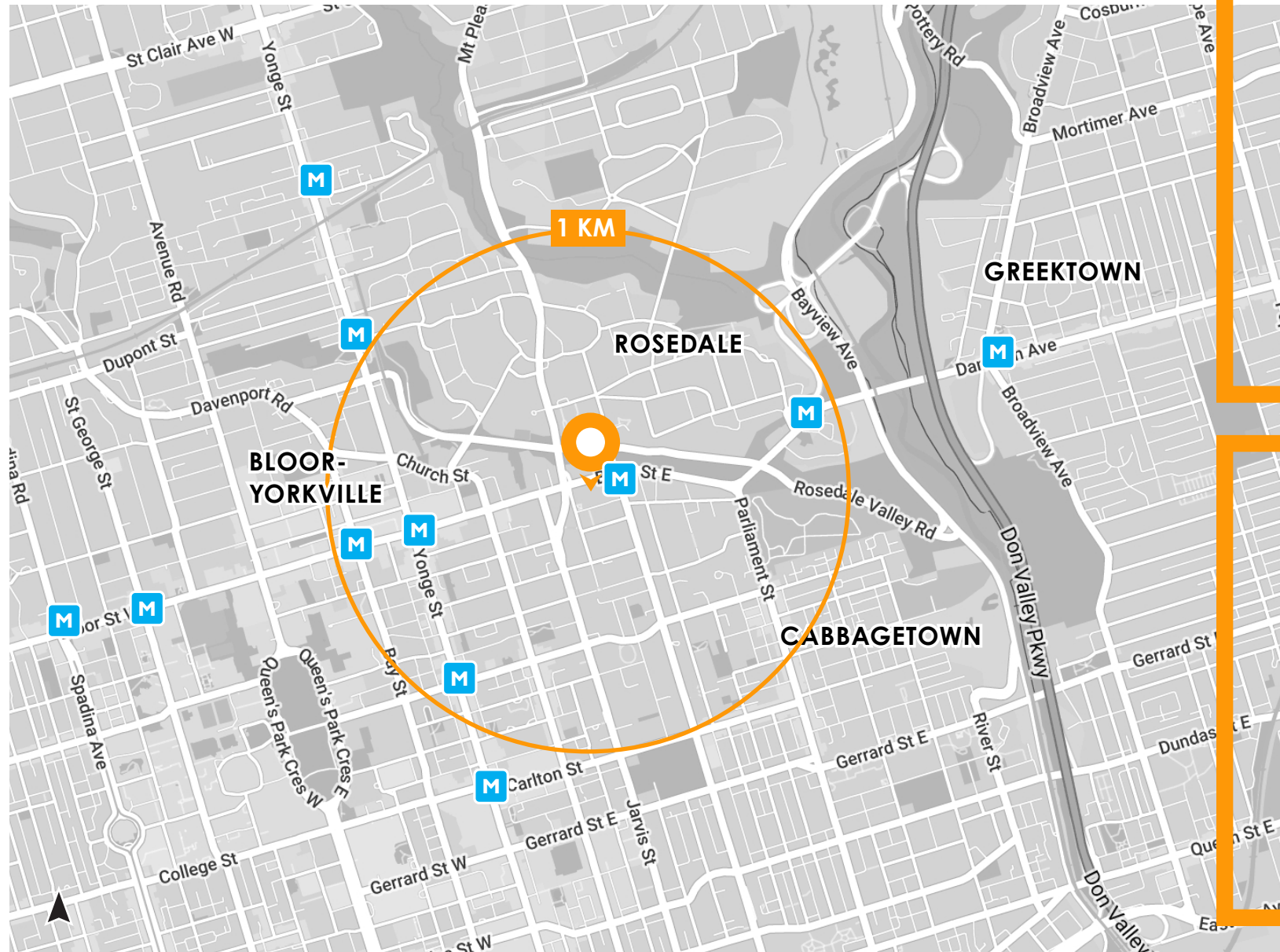

## CENTRALLY LOCATED

- Located at the busy intersection of Bloor St E & Sherbourne Street, just outside St. James Town, the most densely populated census tract in Canada
- Bloor-Yorkville is just west of the property, where you will find luxury shopping and upscale dining
- Head east on Bloor to Greektown, famous for its Greek cuisine and annual *Taste of the Danforth* event, Canada's largest street festival
- To the south is Cabbagetown, a highly desirable neighbourhood known for its large concentration of beautifully restored Victorian homes
- Just passed Rosedale Valley to the north is Rosedale, one of Toronto's most prestigious neighbourhoods, known for its large homes and tree-lined streets

## TRANSIT CONNECTED

- Located directly on the Bloor-Danforth subway line making it easily accessible from anywhere in the city
- Steps from Sherbourne subway station and within walking distance to Bloor-Yonge station
- 20 minute subway ride to the Financial Core
- Easy access to the Don Valley Parkway & Bayview Avenue







# Contact

ARLIN MARKOWITZ\*  
Executive Vice President  
416 815 2374  
arlin.markowitz@cbre.com

ALEX EDMISON\*  
Senior Vice President  
416 874 7266  
alex.edmison@cbre.com

JACKSON TURNER\*\*  
Senior Vice President  
416 815 2394  
jackson.turner@cbre.com

TEDDY TAGGART\*  
Vice President  
416 847 3254  
teddy.taggart@cbre.com

EMILY EVERETT\*  
Sales Associate  
647 943 4185  
emily.everett@cbre.com

\*Sales Representative \*\*Broker

## CBRE

This disclaimer shall apply to CBRE Limited, Real Estate Brokerage, and to all other divisions of the Corporation; to include all employees and independent contractors ("CBRE"). The information set out herein, including, without limitation, any projections, images, opinions, assumptions and estimates obtained from third parties (the "Information") has not been verified by CBRE, and CBRE does not represent, warrant or guarantee the accuracy, correctness and completeness of the Information. CBRE does not accept or assume any responsibility or liability, direct or consequential, for the Information or the recipient's reliance upon the Information. The recipient of the Information should take such steps as the recipient may deem necessary to verify the Information prior to placing any reliance upon the Information. The Information may change and any property described in the Information may be withdrawn from the market at any time without notice or obligation to the recipient from CBRE. CBRE and the CBRE logo are the service marks of CBRE Limited and/or its affiliated or related companies in other countries. All other marks displayed on this document are the property of their respective owners. All Rights Reserved.