

1200 Castlefield Avenue

NORTH YORK, ON



FOR LEASE

MULTIPLE CONFIGURATIONS OF
SHOWROOM/RETAIL/OFFICE/INDUSTRIAL SPACE

Property Overview

Available Space	Ground Floor: 16,498 sq. ft.
	Unit A: 6,850 sq. ft.
	Unit B: 9,650 sq. ft.
Clear Height	10 ft. 8 in.
Shipping Doors	Ground Floor: 2 Truck Level, 1 Drive-in
	Unit A: 1 Truck Level
	Unit B: 2 Truck Level
Zoning	Prestige Employment Zone (PE)
Asking Rate	Ground Floor: \$14.75 per sq. ft.
	Unit A: \$17.95 per sq. ft.
	Unit B: \$17.95 per sq. ft.
TMI (2024)	\$6.95 per sq. ft.
Possession	Immediate

- Prime direct exposure on to Castlefield, an arterial route to and from many high-end showrooms/retailers and adjacent affluent residential neighbourhoods including Forest Hill and Cedarvale.
- In the heart of the Designer District.
- Very clean and functional space.
- Can accommodate many different uses include showroom, retail, office, industrial etc.
- Large windows provide abundant natural light.
- Great for any home decor use such as tile/flooring showroom, plumbing showroom, furniture, kitchen etc.
- Ample free customer parking available.

Zoning Information

PERMITTED USES - PRESTIGE EMPLOYMENT ZONE (PE)

Showroom Uses	+ Retail and/or Showroom Uses: Ideal for showcasing and selling goods
	+ Design Centre: High-visibility space for design product displays
	+ Art Studio: Creative studio for making and selling artwork
Retail Uses	+ Retail Store: Strong exposure for consumer sales
	+ Restaurant: Great location for dine-in traffic
	+ Restaurant - Licensed: Suited for full-service dining with alcohol
	+ Snack Bar: Convenient spot for quick bites
	+ Take-Out Eating Establishment: High-turnover location for takeout service
	+ Banquet Hall: Accessible venue for large events
Office Uses	+ Recreational Uses: Active space for fitness, leisure, or entertainment
	+ Business Service Establishments: Central location for business to business services
	+ Office Uses: Professional space with excellent access
	+ Day Nursery: Easily accessible for childcare facility
Industrial Uses	+ Industrial Uses: Functional space with logistical convenience



1200 Castlefield Avenue
North York, ON

Amenities

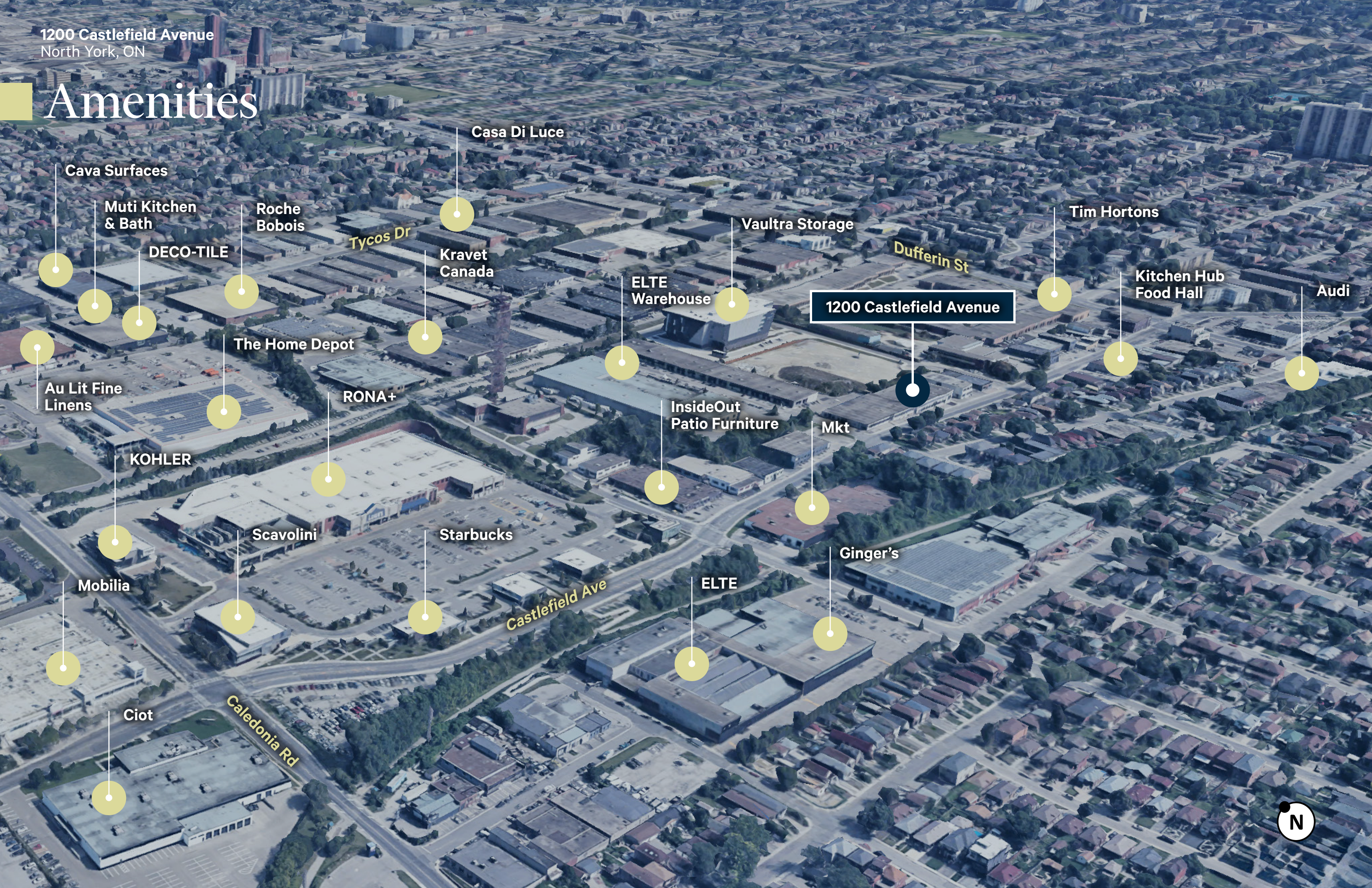

Cava Surfaces

Muti Kitchen
& Bath

DECO-TILE

Roche
Bobois

Casa Di Luce

Kravet
Canada

Vaultra Storage

Tim Hortons

Kitchen Hub
Food Hall

Audi

1200 Castlefield Avenue

ELTE
Warehouse

InsideOut
Patio Furniture

Mkt

Ginger's

ELTE

Starbucks

Scavolini

KOHLER

Au Lit Fine
Linens

The Home Depot

RONA+

Mobilia

Ciot

N

Floor & Site Plan

- Unit A - 6,850 SF
- Unit B - 9,650 SF

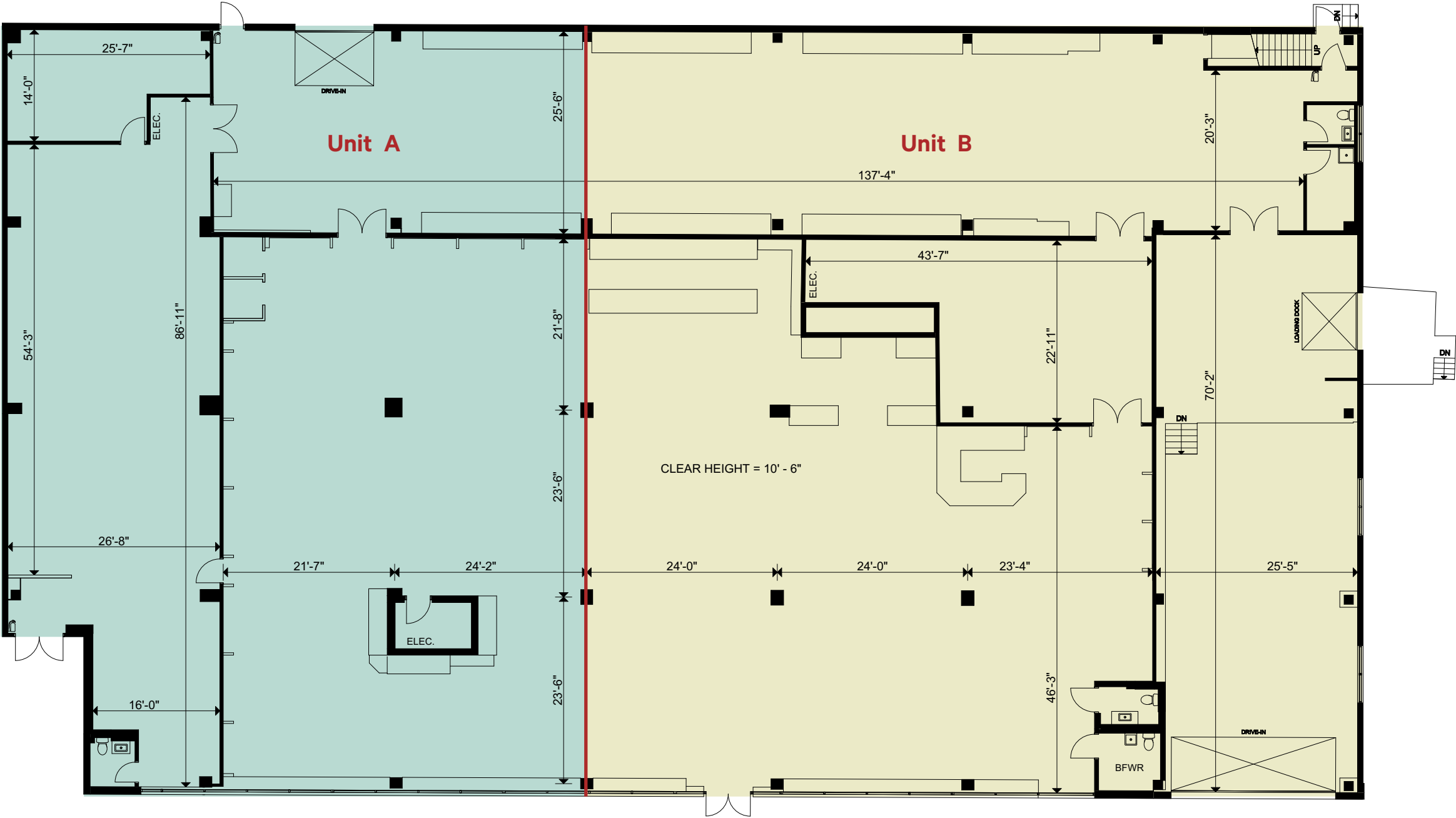

1200 Castlefield Avenue
North York, ON

Property Photos

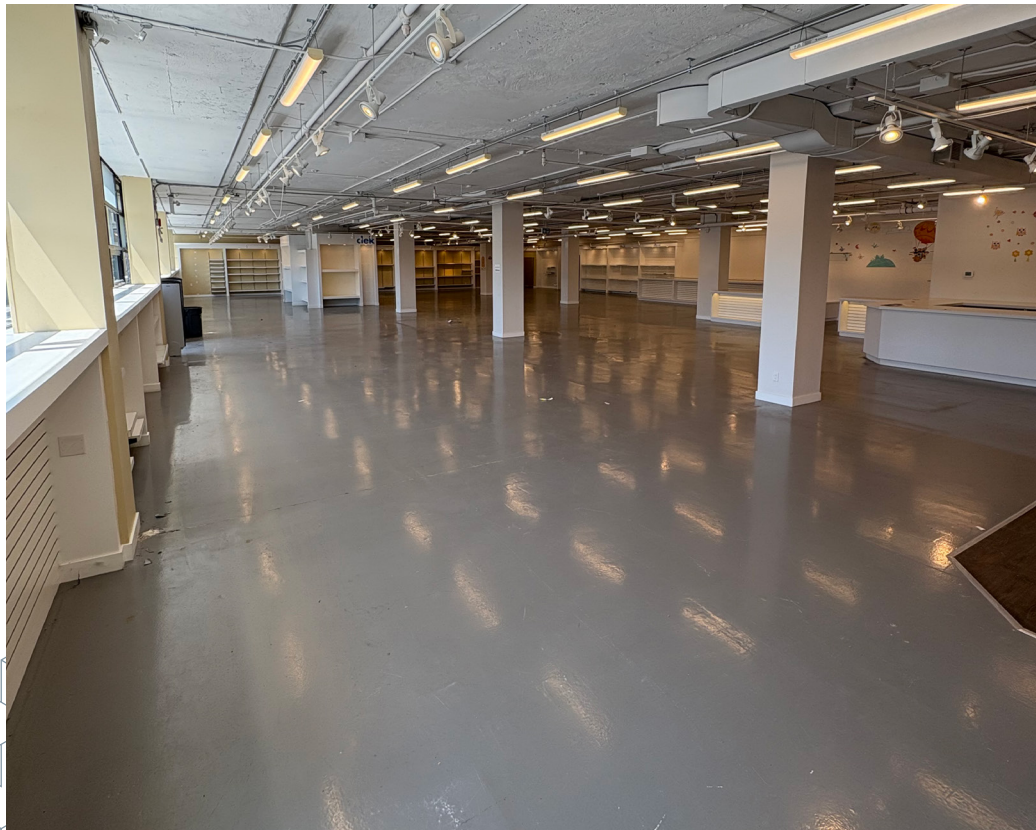

1200 Castlefield Avenue

NORTH YORK, ON



1200 Castlefield Avenue

Castlefield Ave

Fairbank Ave

Contact Us

CBRE Limited, Brokerage

2005 Sheppard Ave., E #800, Toronto, ON | cbre.ca

Terry Di Felice*, MBA
Senior Vice President
+1 416 495 6209
terry.difelice@cbre.com

Justin McNamara*
Senior Sales Associate
+1 416 495 6226
justin.mcnamara@cbre.com

Arlin Markowitz*
Executive Vice President
+1 416 815 2374
arlin.markowitz@cbre.com

Alex Sgro
Sales Representative
+1 416 495 6311
alex.sgro@cbre.com

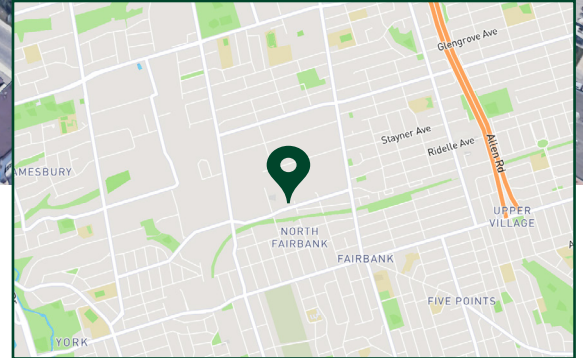

*Sales Representative | All Outlines Are Approximate | CBRE Limited, Brokerage | 2005 Sheppard Ave. E., #800, Toronto, ON M2J 5B4

This disclaimer shall apply to CBRE Limited, Real Estate Brokerage, and to all other divisions of the Corporation; to include all employees and independent contractors ("CBRE"). The information set out herein, including, without limitation, any projections, images, opinions, assumptions and estimates obtained from third parties (the "Information") has not been verified by CBRE, and CBRE does not represent, warrant or guarantee the accuracy, correctness and completeness of the Information. CBRE does not accept or assume any responsibility or liability, direct or consequential, for the Information or the recipient's reliance upon the Information. The recipient of the Information should take such steps as the recipient may deem necessary to verify the Information prior to placing any reliance upon the Information. The Information may change and any property described in the Information may be withdrawn from the market at any time without notice or obligation to the recipient from CBRE. CBRE and the CBRE logo are the service marks of CBRE Limited and/or its affiliated or related companies in other countries. All other marks displayed on this document are the property of their respective owners. All Rights Reserved. Mapping Sources: Canadian Mapping Services canadamapping@cbre.com; MapPoint, DMTI Spatial, Environics Analytics, Microsoft Bing, Google Earth.

www.cbre.ca

CBRE